

V2



## *Installation manual*



## *Benz W168 7inch Wince*

*Are you ready to install our unit?*

*Let's go >>>*

# 4 steps to install

**STEP 01** Check  
1) Do the screen is broken ?  
2) Do the accessories have missing ?

**STEP 02** Test your unit before a full installation.  
(Connect the power cable to your car)

**STEP 03** Do the full installation.

**STEP 04** Test the head unit functions.

## Accessories



- 1. Antenna adapter \*1
- 2. SD card cover \*1
- 3. Disassembly tool \*1
- 4. Canbus \*1
- 5. User manual \*1
- 6. GPS antenna \*1
- 7. Radio Antenna Adapter Cable \*1
- 8. USB adapter cable \*1
- 9. USB adapter cable \*1
- 10. Power cable \*1

# STEP 02 Test your unit before installing into your car (Connect the power cable to your car)

1. Double check the size and shape of the center console panel.



2. Well prepare below tools.

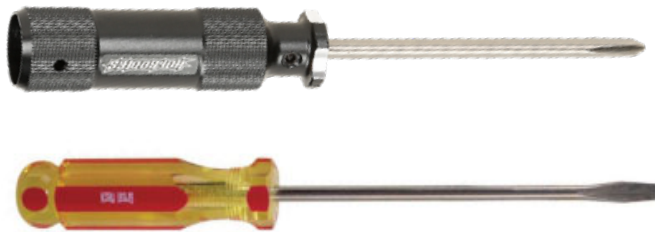

The installation methods among the application models are almost the same, below is the installation guide to show you how to install the unit to Benz W203.

3. First of all, remove the surrounded cover of gear knob.



4. Then pry out the cigarette console at the gap (red circle) with a screwdriver and take it out.

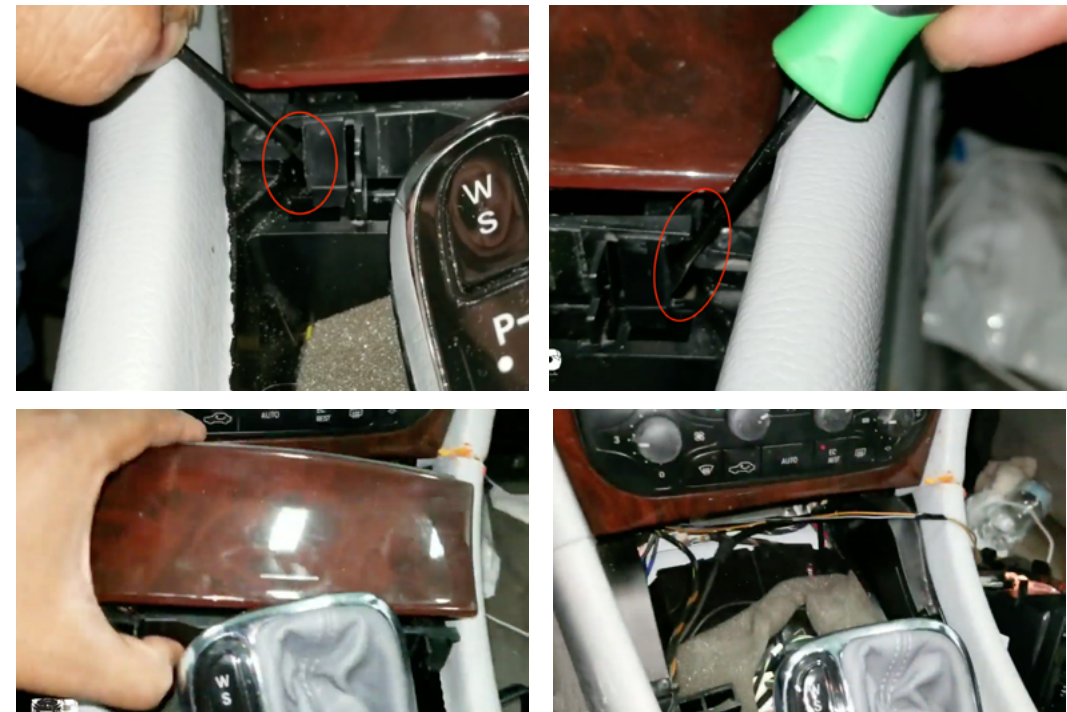

5. After that, go to remove the interior middle section air vents. Use the screwdriver to pull the inside switch in the air vents, then it will drop down. Besides, use the screwdriver to pry out the whole interior middle section air vents at the top of switch.

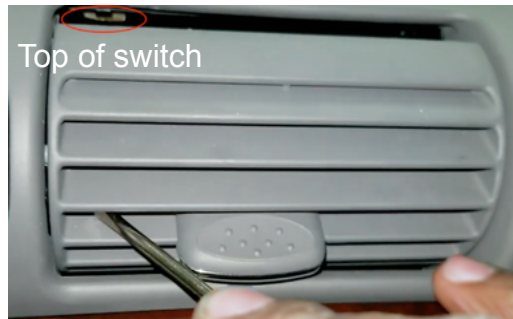
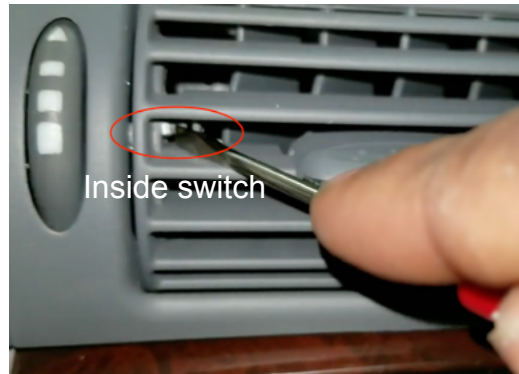

8. Now the factory old radio exposes out, you will see the screw at the left and right side, unscrew them.

6. After removing the interior middle section air vents, you will find the screws at the left and right side that is used to lock the cover of center console, unscrew them.



7. Moreover, move to the middle of center console, you can easily pull out the cover of center console with the screwdriver at the position of red circle.

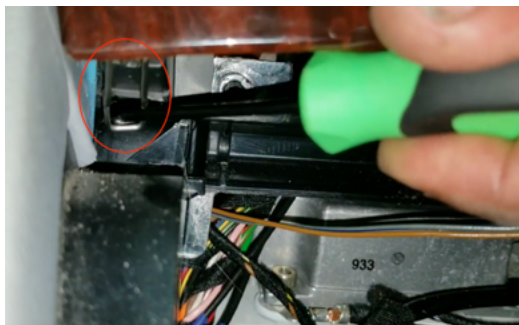

9. Then the factory old radio and the storage box can be pulled out thoroughly.

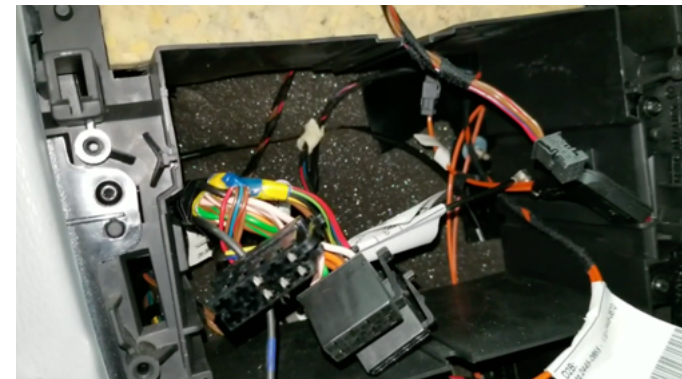

Now you can take out the power cable to connect the head unit and then try to turn it on. If this part is no problem, you can do the remain steps.

# STEP 03 Do the full installation.

10. Connect those wires provided in the package like (1) GPS antenna, (2) Radio antenna adapter cable, (3) USB cable, (4) External microphone, (5) Canbus and (6) Power cable as shown.



## Wiring diagram



Working voltage:DC12V  
Current: MAX15A

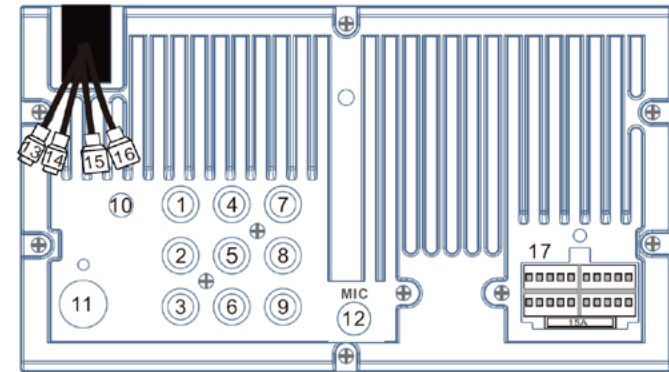

- |                                |                 |
|--------------------------------|-----------------|
| ① SUB WOOFER                   | ⑩ GPS antenna   |
| ② Front and right audio output | ⑪ Radio antenna |
| ③ Front and left audio output  | ⑫ Rear MIC      |
| ④ Video output 2               | ⑬ Video output2 |
| ⑤ Rear and right audio output  | ⑭ USB 1         |
| ⑥ Rear and left audio output   | ⑮ USB 2         |
| ⑦ Video input                  | ⑯ Camera input  |
| ⑧ Right audio input            | ⑰ Power cable   |
| ⑨ Left audio input             |                 |

### ⑰ POWER SUPPLY PORT



- |           |                |
|-----------|----------------|
| ① GND     | ⑪ B+           |
| ② Fear L+ | ⑫ Fear L-      |
| ③ Fear R+ | ⑬ Fear R+      |
| ④ Rear L+ | ⑭ Rear L-      |
| ⑤ Rear R+ | ⑮ Rear R-      |
| ⑥ REVERSE | ⑯ ANT/AMP-CTRL |
| ⑦ WKEY1   | ⑰ ILL          |
| ⑧ ACC     | ⑱ BRAKE        |
| ⑨ WKEY2   | ⑲ WKEY-GND     |
| ⑩ CAN-RX  | ⑳ CAN-TX       |

11. Place the GPS antenna and microphone as shown. The wires are hidden in the side of pillar trim and led to the head unit.

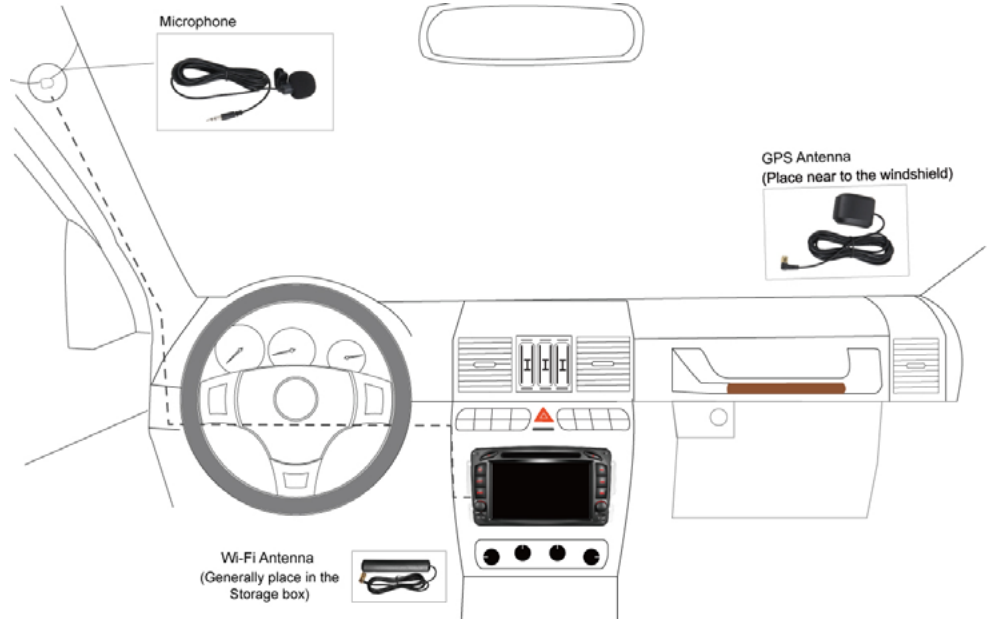

**STEP 04** Test the head unit functions. (FM, SD, USB, Bluetooth, reversing, handbrake, headlight, steering wheel control and etc)

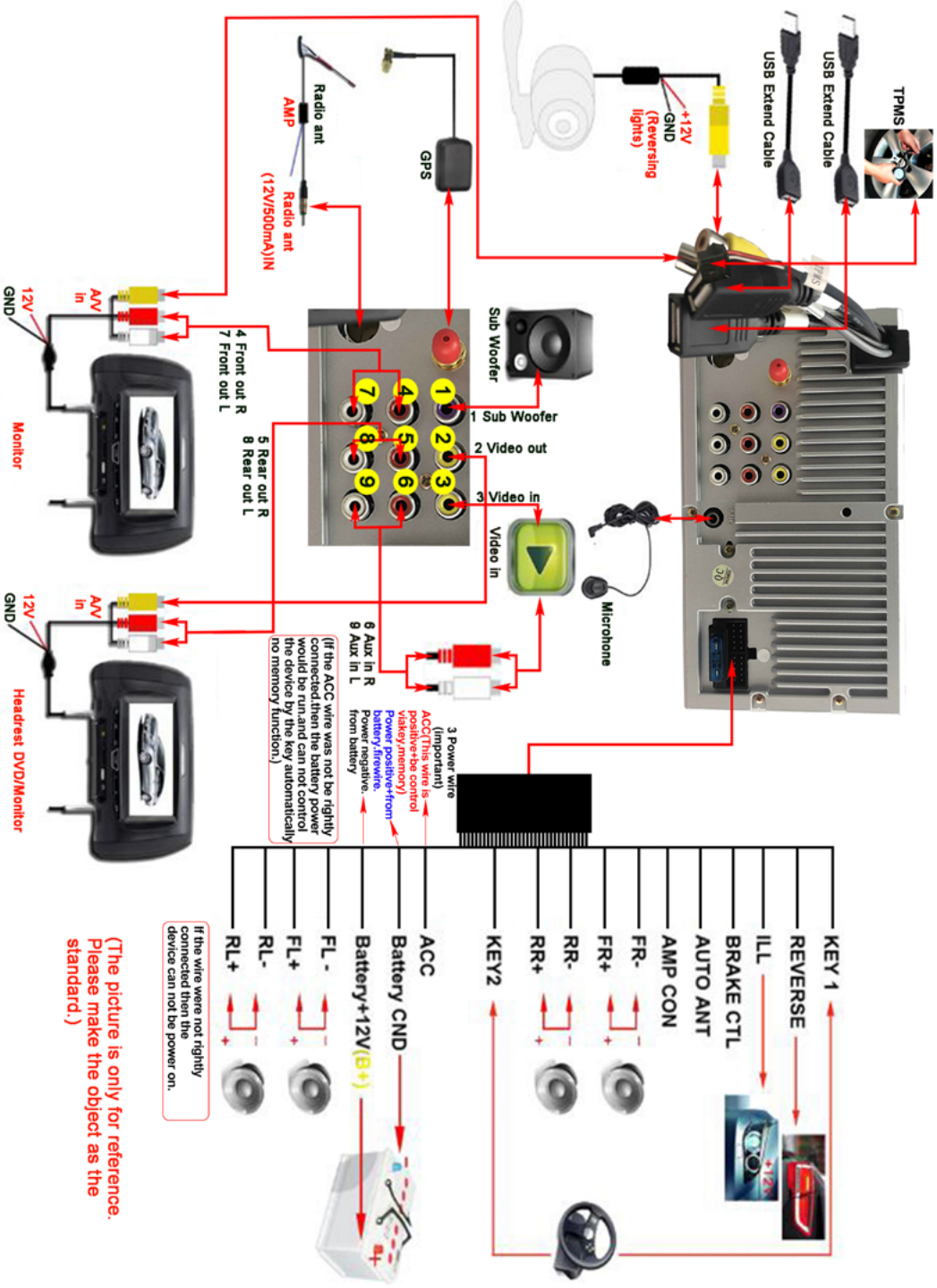
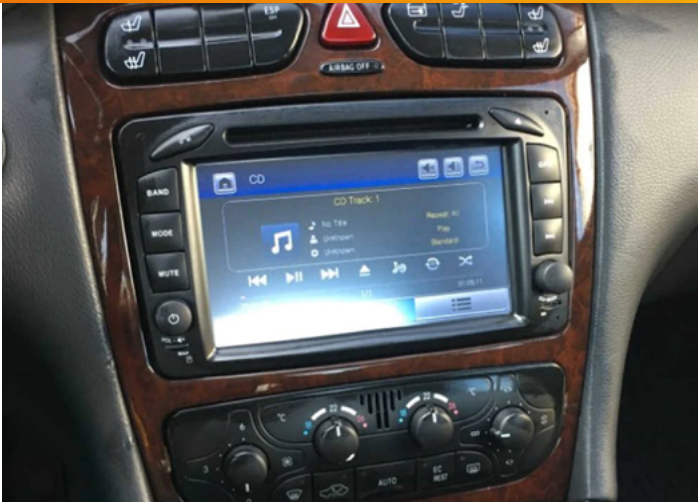

# Wire connection for the amplifier, the subwoofer and the headset monitors

Case 1: The subwoofer connects to the head unit

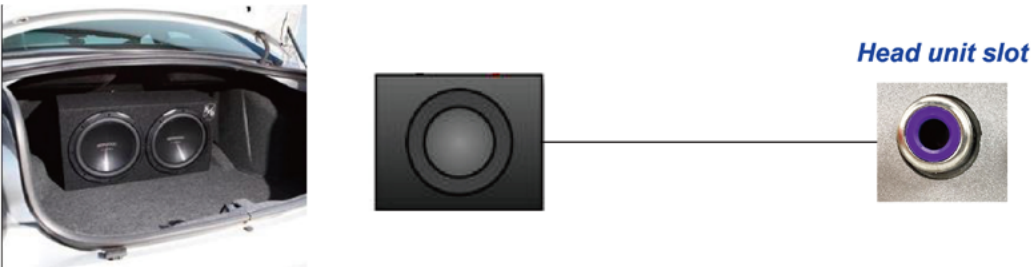

Case 2: The 2/4 speakers with an amplifier are connected to the head unit.

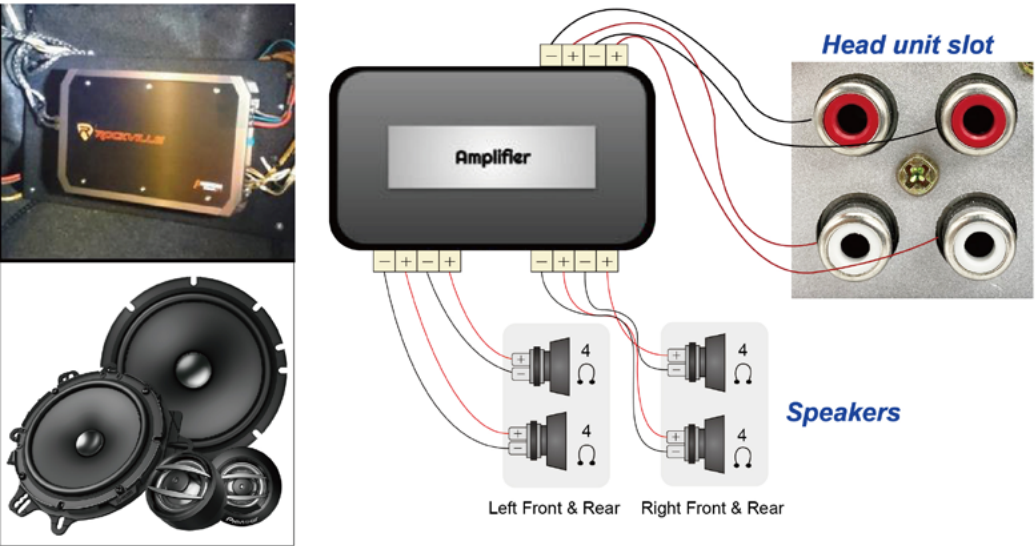

Case 3: The 2/4 speakers with an amplifier and the subwoofer with an amplifier are separately connected to the head unit.

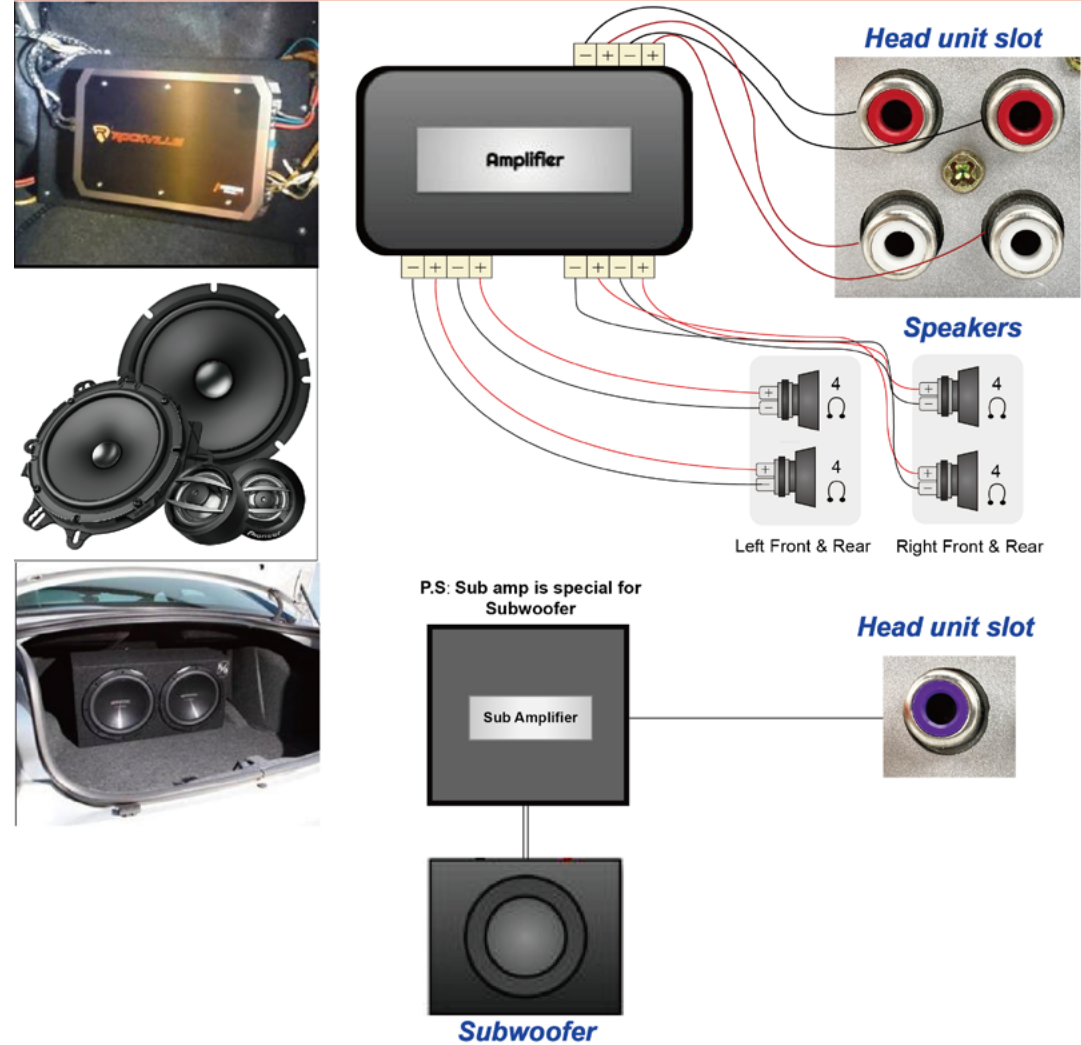

Case 4: The headrests monitors are connected to the head unit

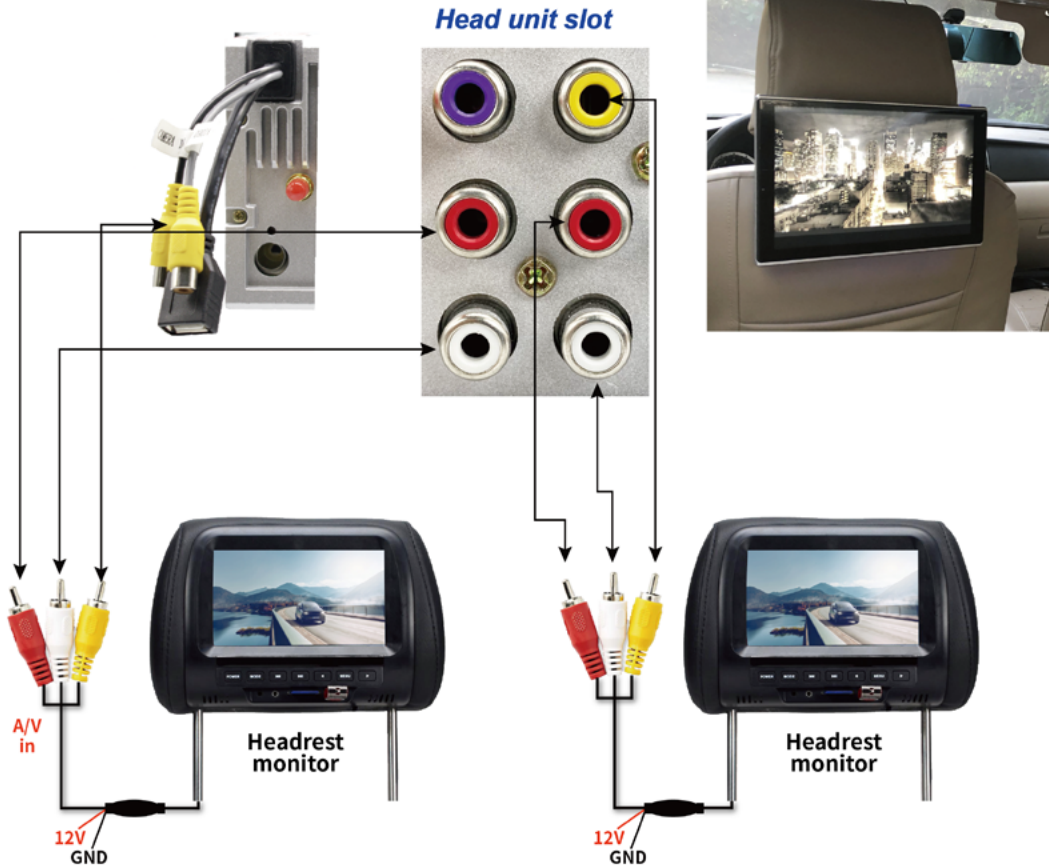

Except for connecting the amplifier, the slot of FL, FR, RL, RR also are used for connecting the headrest monitors.

Optional : Reverse camera installation instruction

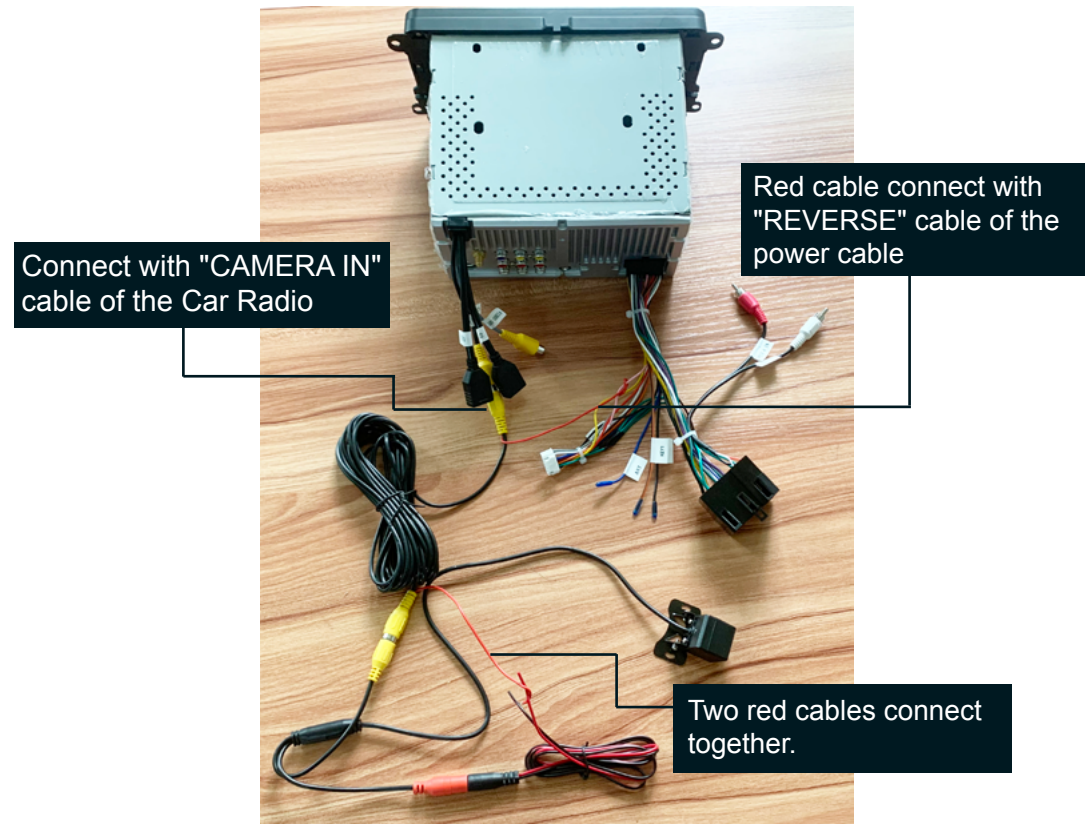

Trouble Shooting:

1. Confirm that all the lines are connected. The car is hung to the reverse gear and the display switches to the reverse mode. If the screen does not switch, please check whether the reverse detection line is connected to the reverse lamp power supply line and has a voltage of about 12V. If not, please connect it perfectly.
2. When the car is in the reverse gear position and the display switches to the reverse model but there is no video display, then check that the camera power supply and video signal cable are correctly connected to the reverse video signal line input plug(CAMERA IN) on the machine.