

V2



## *Installation manual*



## *Volkswagen 7-9inch Wince*

*Are you ready to install our unit?*

*Let's go >>>*

# 4 steps to install

## STEP 01

Check

- 1) Do the screen is broken ?
- 2) Do the accessories have missing ?

## STEP 02

Test your unit before a full installation.  
(Connect the power cable to your car)

## STEP 03

Do the full installation.

## STEP 04

Test the head unit functions.

## Accessories



1. Power cable \*1

3. Canbus \*1

5. USB Adapter Cable \*1

7. User manual \*1

9. External microphone \*1

2. Power cable \*1

4. USB Adapter Cable \*1

6. Radio antenna adapter cable \*1

8. GPS card \*1

10. GPS antenna \*1

# STEP 02 Test your unit before a full installation.

(Connect the power cable to your car)

1. Double check the size and shape of the center console panel.

VW Passat



VW Jetta



VW EOS



VW polo



2. The methods of old radio removal for them are mostly the same. Firstly, need to remove the cover of the old radio with disassembly tool.



3. After that you will discover the each bolts of old radio, then unscrew them, you can pull the whole unit out.



(Remark : In some VW models, the upper bolts may be hidden under the air vents, you need to open the air vents to explore it.)

Now you can take out the power cable to connect the head unit and then try to turn it on. If this part is no problem, you can do the remain steps.

## STEP 03 Do the full installation.

4. Connect those wires provided in the package like (1) GPS antenna, (2) USB cable, (3) Radio antenna adapter cable, (4) External microphone, (5) Power cable with canbus as shown.



## Wiring diagram

FC CE

Working voltage:DC12V  
Current: MAX15A

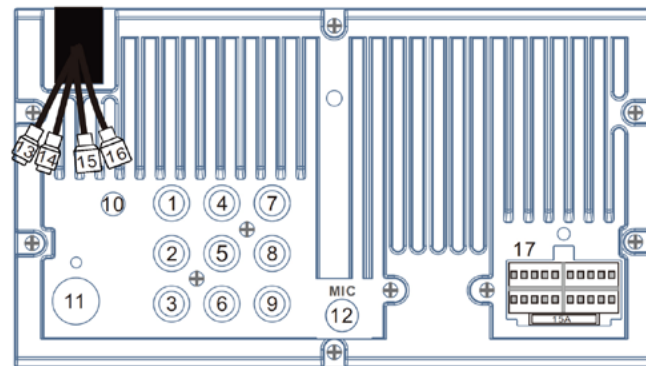

- |                                |                 |
|--------------------------------|-----------------|
| ① SUB WOOFER                   | ⑩ GPS antenna   |
| ② Front and right audio output | ⑪ Radio antenna |
| ③ Front and left audio output  | ⑫ Rear MIC      |
| ④ Video output 2               | ⑬ Video output2 |
| ⑤ Rear and right audio output  | ⑭ USB 1         |
| ⑥ Rear and left audio output   | ⑮ USB 2         |
| ⑦ Video input                  | ⑯ Camera input  |
| ⑧ Right audio input            | ⑰ Power cable   |
| ⑨ Left audio input             |                 |

### ⑰ POWER SUPPLY PORT



- |           |                |
|-----------|----------------|
| ① GND     | ⑪ B+           |
| ② Fear L+ | ⑫ Fear L-      |
| ③ Fear R+ | ⑬ Fear R+      |
| ④ Rear L+ | ⑭ Rear L-      |
| ⑤ Rear R+ | ⑮ Rear R-      |
| ⑥ REVERSE | ⑯ ANT/AMP-CTRL |
| ⑦ WKEY1   | ⑰ ILL          |
| ⑧ ACC     | ⑱ BRAKE        |
| ⑨ WKEY2   | ⑲ WKEY-GND     |
| ⑩ CAN-RX  | ⑳ CAN-TX       |

5. Plug the head unit into the center console, then place the GPS antenna and microphone as shown. The wires are hidden in the side of pillar trim and led to the head unit.

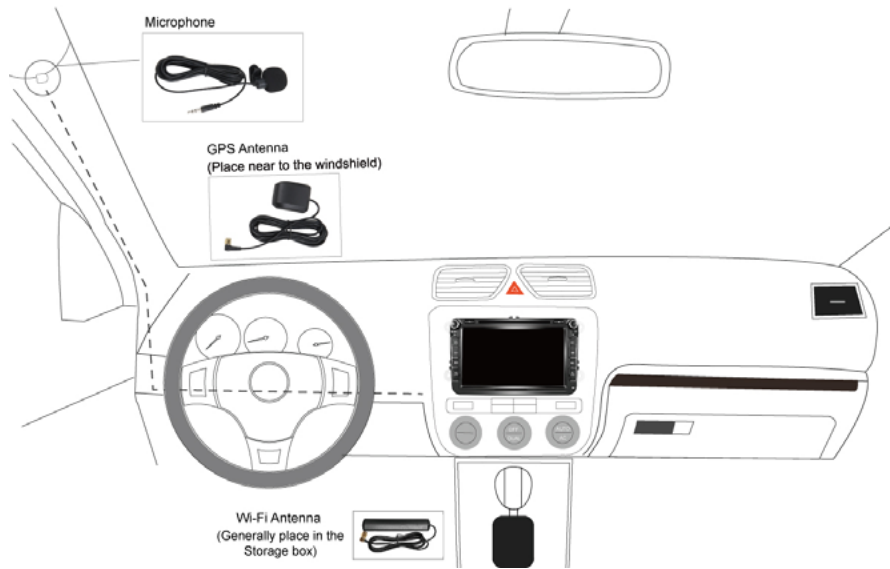

## Wire connection for the amplifier, the subwoofer and the headset monitors

Case 1: The subwoofer connects to the head unit

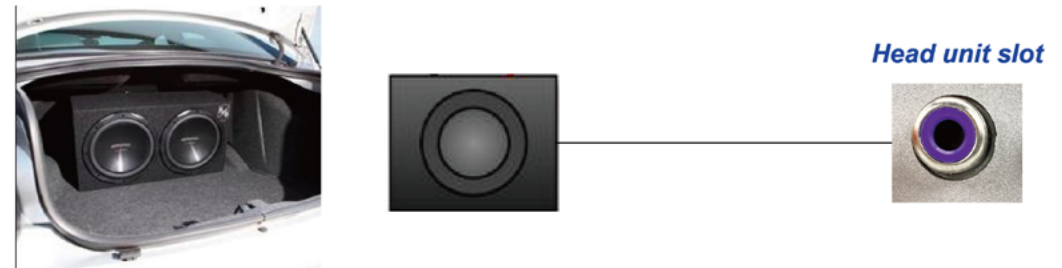

Case 2: The 2/4 speakers with an amplifier are connected to the head unit.

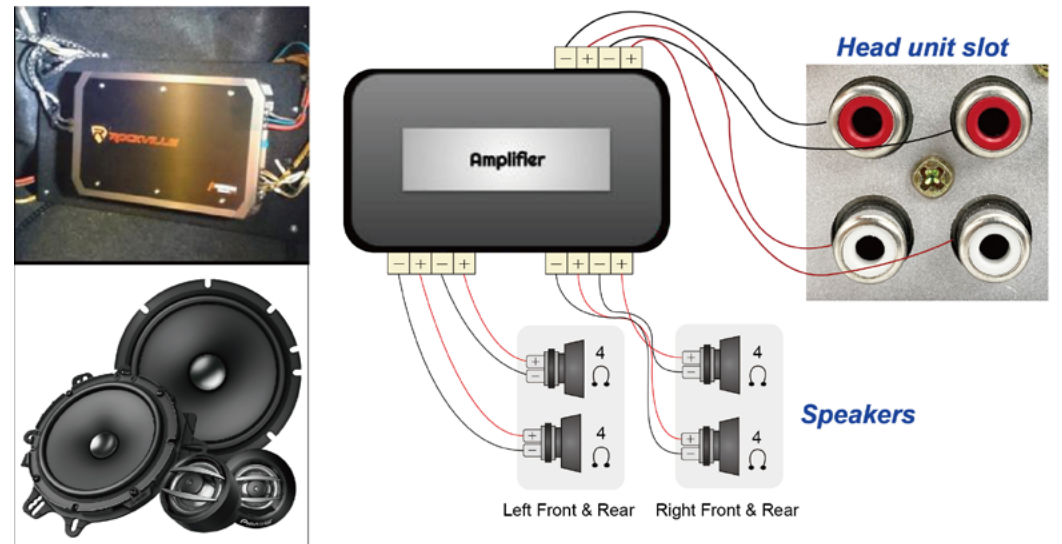

**STEP 04** Test the head unit functions.  
(FM, SD, USB, Bluetooth, reversing, handbrake, headlight, steering wheel control and etc)



Case 3: The 2/4 speakers with an amplifier and the subwoofer with an amplifier are separately connected to the head unit.

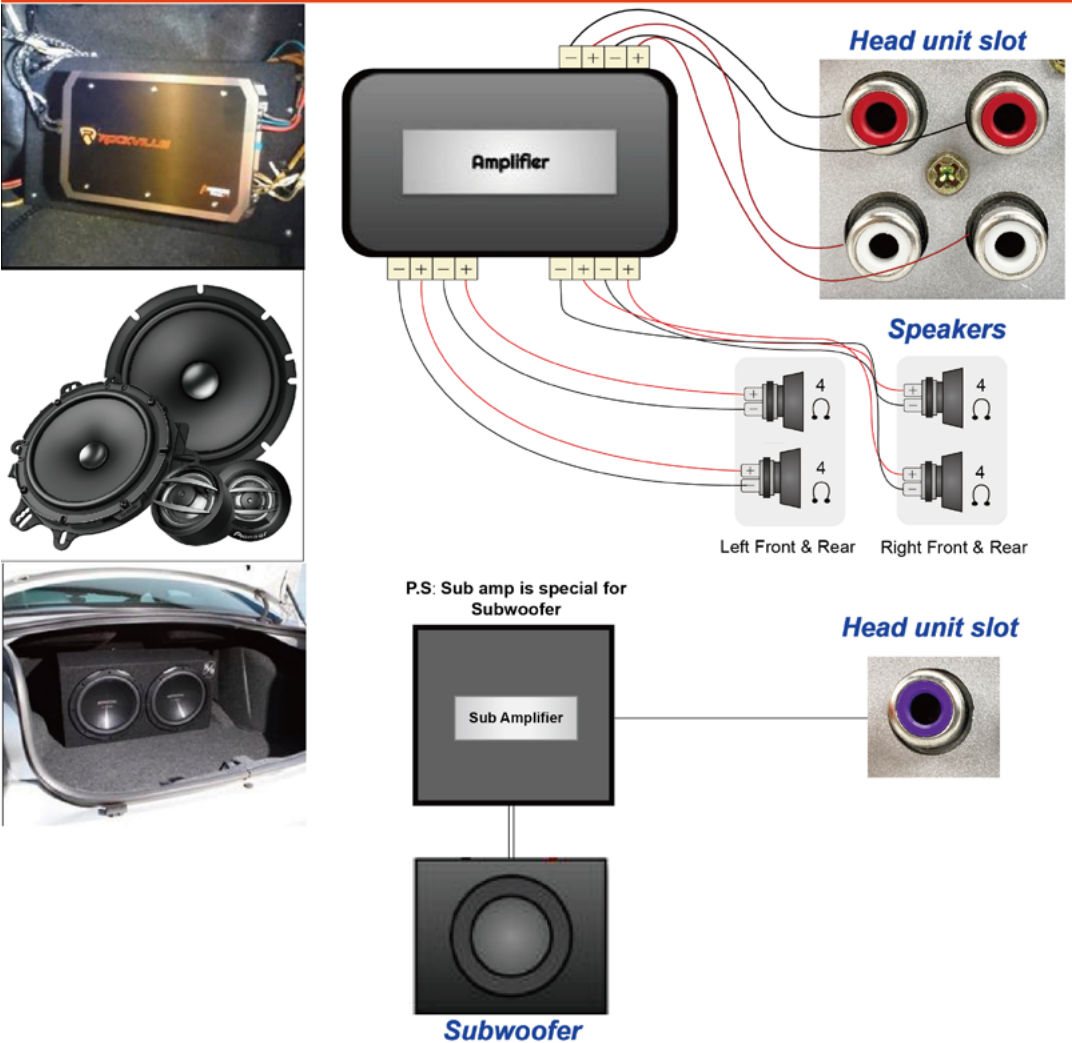

Case 4: The headrests monitors are connected to the head unit

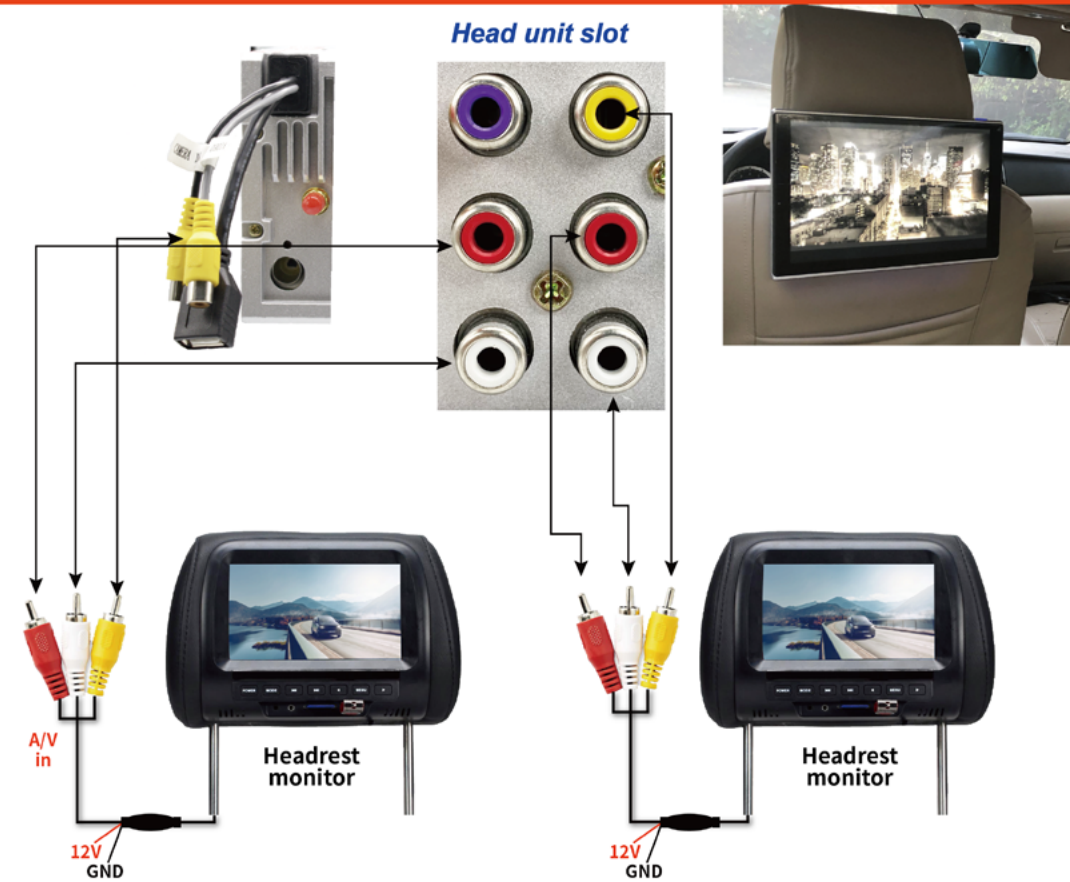

Except for connecting the amplifier, the slot of FL, FR, RL, RR also are used for connecting the headrest monitors.

# Optional : Reverse camera installation instruction

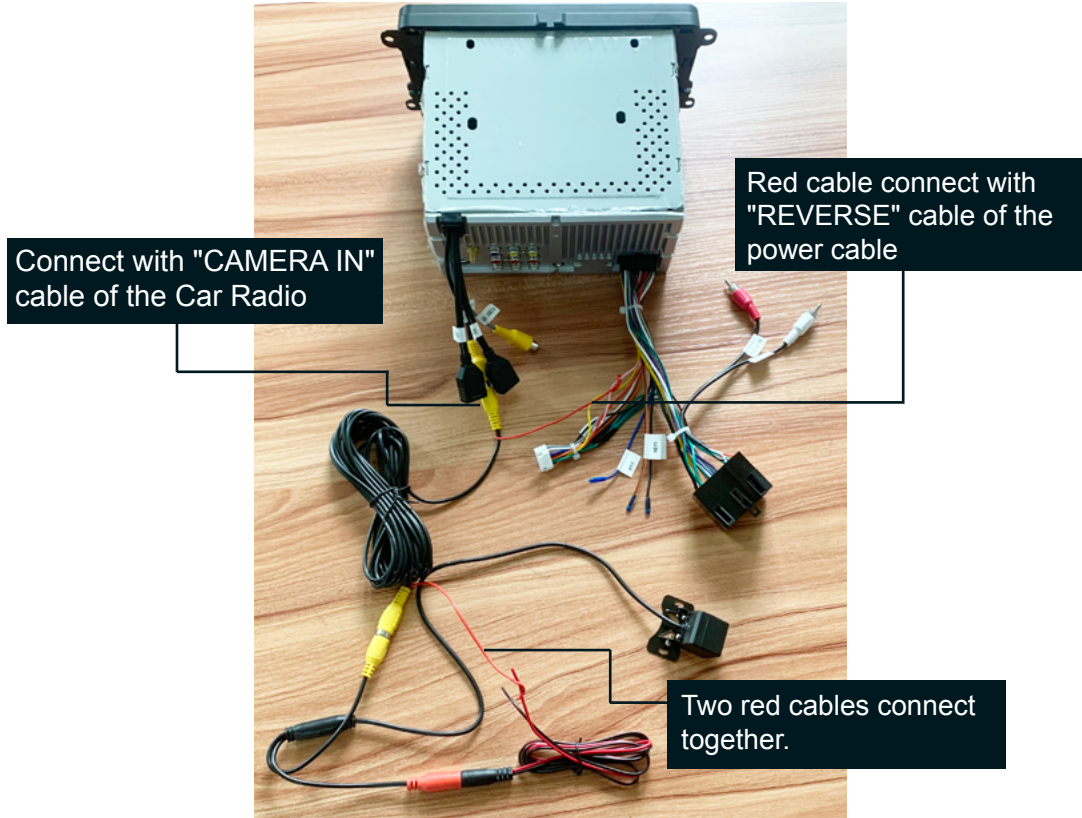

## Trouble Shooting:

1. Confirm that all the lines are connected. The car is hung to the reverse gear and the display switches to the reverse mode. If the screen does not switch, please check whether the reverse detection line is connected to the reverse lamp power supply line and has a voltage of about 12V. If not, please connect it perfectly.
2. When the car is in the reverse gear position and the display switches to the reverse model but there is no video display, then check that the camera power supply and video signal cable are correctly connected to the reverse video signal line input plug(CAMERA IN) on the machine.