

V2



Installation manual



BMW E39 9inch Android

Are you ready to install our unit?

Let's go >>>

5 steps to install

STEP 01 Double check if has any missing before installation.

STEP 02 Check
1) Do the screen is broken ?
2) Do the accessories have missing ?

STEP 03 Test your unit before installing into your car
(Connect the power cable to your car)

STEP 04 Do the full installation.

STEP 05 Test the head unit functions.

STEP 01 Double check if has any missing before installation.

1. Below three situations you will need an extended harness (Not included) for the installation.

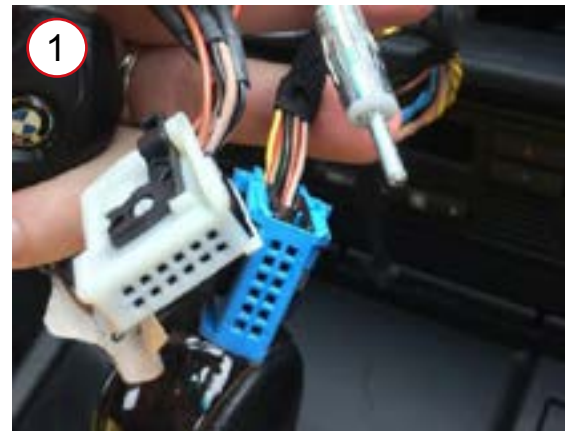

If your car radio plugs are same as shown, those are white and blue color. An extended harness (Not included) is required for installation.



If your car dashes are same as image 2 or image 3, an extended harness (Not included) is required for installation also.

5m extended harness



Please find the ASIN in the listing.

Installation guide

If you are in above three situations, your car should be built-in an amplifier - **BM54/24 tuner** in the trunk area. You need to use the extended harness to connect both of them.



The references of BM54 tuner location



If your car model is X5, the amplifier - BM54/24 tuner will be under the spare tire.

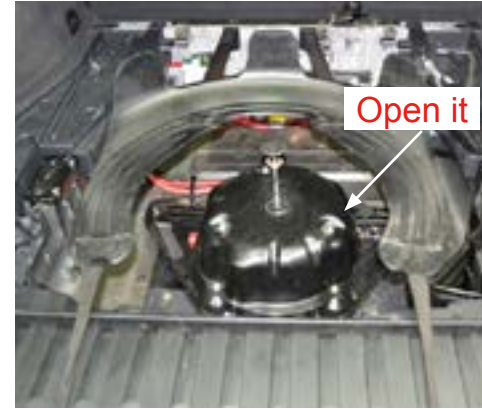

Installation steps

1. Connect the power plug to the new head unit.
2. pull the extension harness to the trunk area as shown.



3. Connect the female radio plug of your car with the male plug of extended harness.



4. Connect the female plug of extension harness with the amplifier - BM54/24 tuner.



2. If the center console has OBC module with a DSP button and you have a black amplifier in the trunk area, your car is a DSP model. Then you need to do some extra work for producing the sound effect.



Center console



Trunk area

Issue:

If you directly install our head unit in this DSP case, you will have no sound.

Resolution:

****This resolution is provided and proved by our clients.****
You need to separately purchase one more application called "I-BUSAPP" and their data cable for producing the sound effect.



Their official website: https://www.ibus-app.de/index_en.html

Please do the research first before you place the order.

STEP 03 Test your unit before installing into your car (Connect the power cable to your car)

1. Double check the size and shape of the center console panel.



2. Below extra tools you may need.



Small flashlight



Monkey Spanner



Phillips screwdriver



Electric drill & head of screwdriver (suggested)



3. Check carefully the car radio plug.

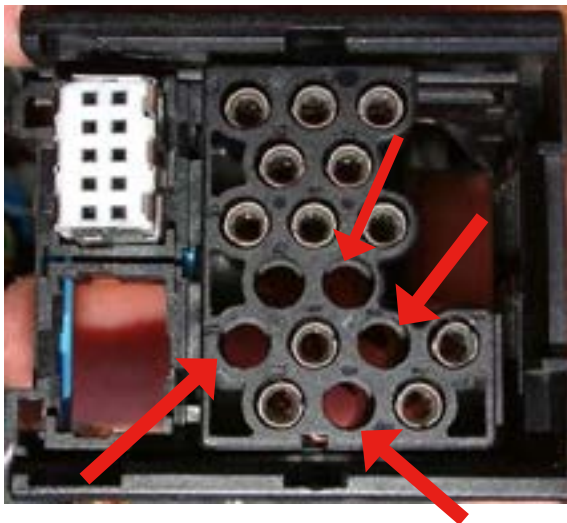

It's not compatible with Amaseaudio head unit if the car radio is 17 pin and lack of 4 pin as shown. If you are this situation, please return the unit to us.

2. First of all is to remove the middle radio. First step is to pull out the button of radio.



3. Then take the Allen wrench from the accessories and plug it into the hole like below image.



4. Turn the Allen wrench left and then you can pull out the whole radio.

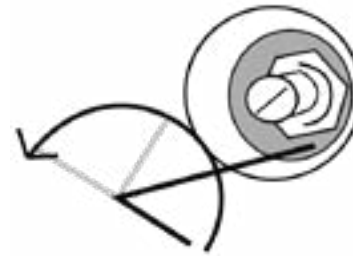

5. Moreover, unplug the cable connected behind the radio.



6. Now start to remove the upper CD player, open the cover.



7. Use the Allen wrench to unscrew the bolts at the left and right side of CD player like below images.



8. After that, you can pull out the CD player and unplug all the cable connected to the backside of player

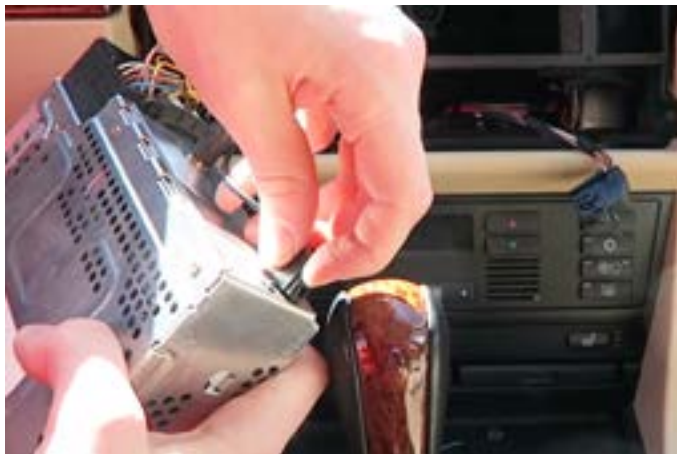

Now you can take out the power cable to connect the head unit and then try to turn it on. If this part is no problem, you can do the remain steps.

STEP 04 Do the full installation.

9. Now need to take the old radio bracket out.



10. Before that, you need to unscrew the bolts of surrounding cover.



(PS. The red arrow is the approximate position of bolts, there are around eleven bolts)

11. Remove the cover with disassembly tool, then you can get start to unscrew the bolts.



12. After that, you can take out the old radio bracket.



13. Screw back the bolts and then install the new bracket to the both side of console.



14. Connect those wires provided in the package like (1) Power cable with canbus, (2) USB cable, (3) Radio antenna adapter cable, (4) GPS antenna, (5) Wi-fi antenna and (6) External microphone etc.

15. Plug the head unit into the center console, then place the GPS antenna and microphone as shown. The wires are hidden in the side of pillar trim and led to the head unit.

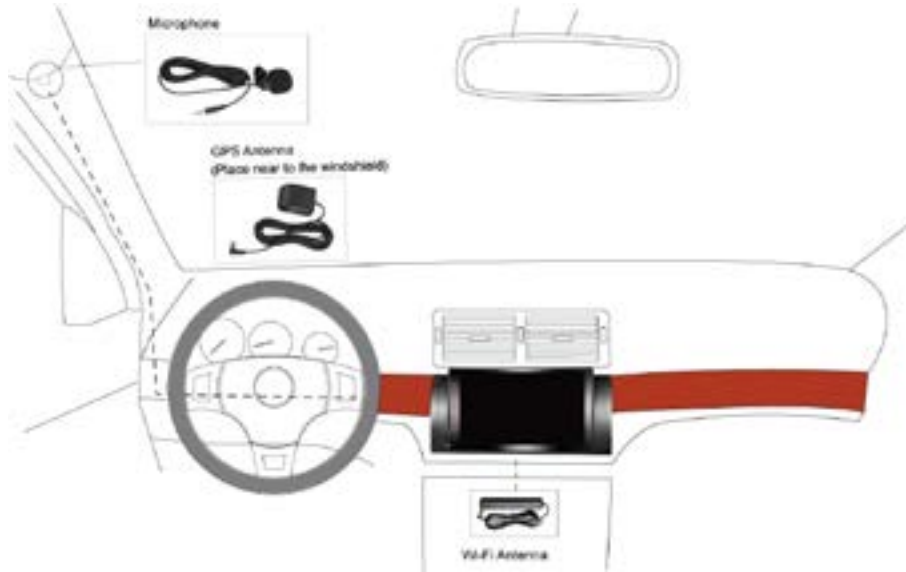

STEP 05

Test the head unit functions.

(FM, SD, USB, Bluetooth, reversing, handbrake, headlight, steering wheel control and etc)

