



Installation manual



Audi A3 7inch Android

Are you ready to install our unit?
Let's go >>>

4 steps to install

STEP 01

Check

- 1) Do the screen is broken ?
- 2) Do the accessories have missing ?

STEP 02

Test your unit before a full installation.
(Connect the power cable to your car)

STEP 03

Do the full installation.

STEP 04

Test the head unit functions.

Accessories



1. External microphone *1

2. GPS antenna *1

3. Wifi antenna *1

4. Disassembly Key *1

5. Canbus *1

6. Antenna adapter *1

7. 15A fuse *1

8. 3M adhesive *1

9. Disassembly tools *4

10. Power cable *2

11. Radio Antenna connector *1

12. USB adapter cable *1

13. USB adapter cable *1

14. USB adapter cable *1

12. USB adapter cable *1

13. USB adapter cable *1

14. USB adapter cable *1

15. USB adapter cable *1

16. USB adapter cable *1

17. USB adapter cable *1

18. USB adapter cable *1

19. USB adapter cable *1

STEP 02 Test your unit before a full installation.

(Connect the power cable to your car)

1. Double check the size and shape of the center console panel.



2. Prepare the disassembly tools. (No.9)

3. Insert the DT into the small holes of each corners on the factory unit.

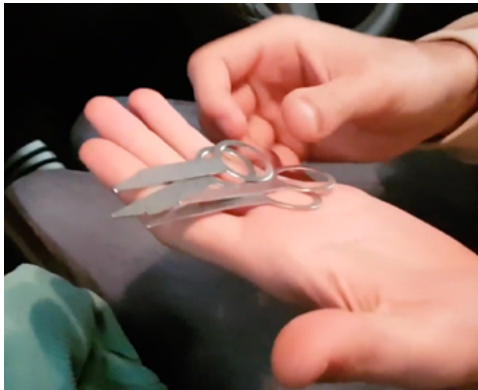

5. Then you can totally pull out the factory unit with the DT.



6. Unplug all cables from the factory unit.



7. Remove the surrounding cover with disassembly tools, release more space for connecting the cables.



Now you can take out the power cable to connect the head unit and then try to turn it on. If this part is no problem, you can do the remain steps.

STEP 03 Do the full installation.

8. Connect those wires provided in the package like (1) Power cable with canbus, (2) USB cable, (3) Radio antenna adapter cable, (4) GPS antenna, (5) Wi-fi antenna and (6) External microphone as shown.

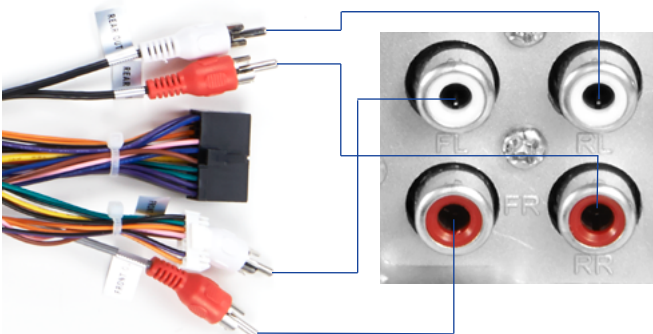
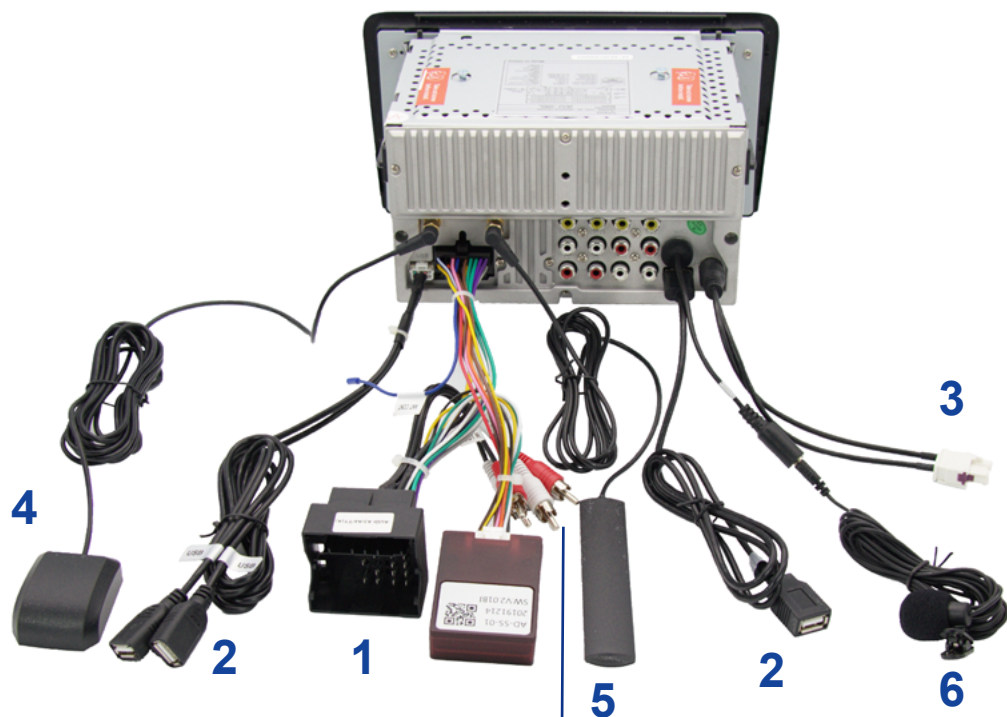

If your car has built-in the factory amplifier, you need to connect the red and white cable on the power cable to the red and white plug of head unit.

Wiring diagram

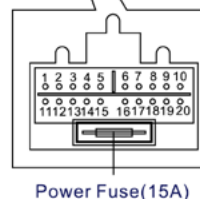
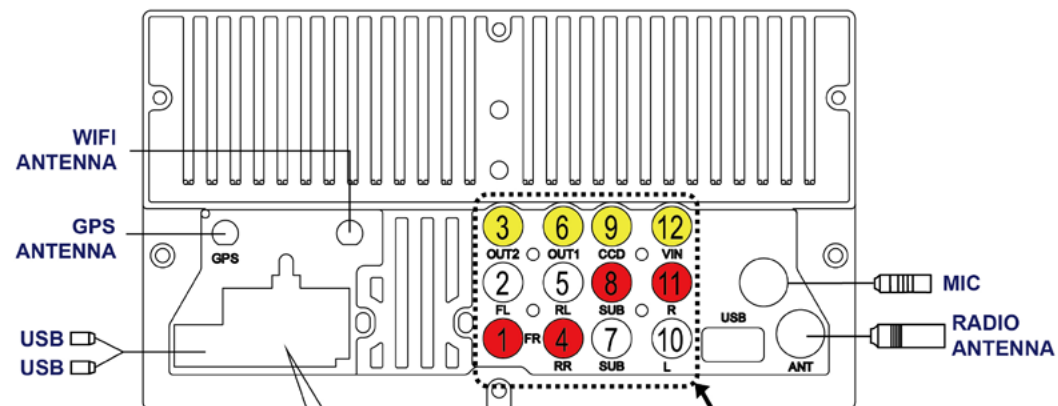

- | | |
|-----------------------------|--------------------------|
| 1. Power amplifier control | 11. CANBUS TX (IR) |
| 2. Steering wheel control 2 | 12. CANBUS RX (GND) |
| 3. Steering wheel control 1 | 13. ILLUMI |
| 4. Brake wire | 14. Accessory |
| 5. Auto antenna power | 15. Ground |
| 6. Rearview control wire | 16. Power+12V |
| 7. Rear left speaker- | 17. Front left speaker- |
| 8. Rear left speaker+ | 18. Front left speaker+ |
| 9. Rear right speaker- | 19. Front right speaker- |
| 10. Rear right speaker+ | 20. Front right speaker+ |

- | |
|---|
| 1. (FR) FRONT RIGHT AUDIO OUTPUT (RED) |
| 2. (FL) FRONT LEFT AUDIO OUTPUT (WHITE) |
| 3. VIDEO 2 OUT (YELLOW) |
| 4. (RR) REAR RIGHT AUDIO OUTPUT (RED) |
| 5. (RL) REAR LEFT AUDIO OUTPUT (WHITE) |
| 6. VIDEO 1 OUT (YELLOW) |
| 7. SUB OUT (WHITE) |
| 8. SUB OUT (RED) |
| 9. REAR CAMERA INPUT (YELLOW) |
| 10. (L) CH INPUT (WHITE) |
| 11. (R) CH INPUT (RED) |
| 12. VIDEO IN (YELLOW) |

9. Plug the head unit into the center console, then place the GPS antenna and microphone as shown. The wires are hidden in the side of pillar trim and led to the head unit.

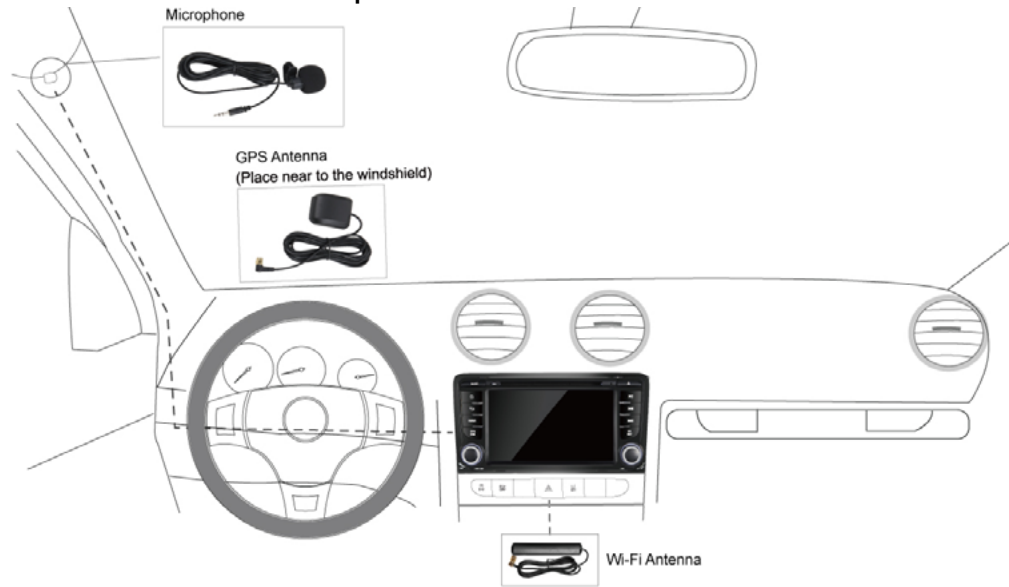

STEP 04 Test the head unit functions.

(FM, SD, USB, Bluetooth, reversing, handbrake, headlight, steering wheel control and etc)

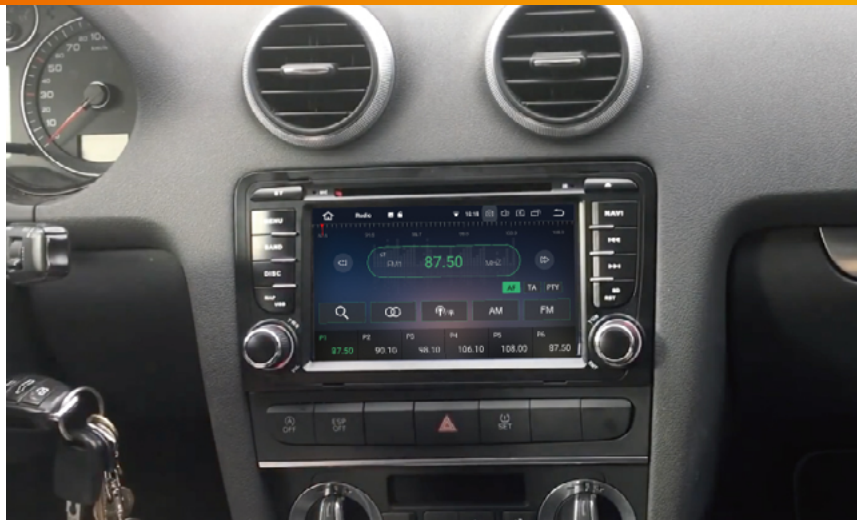

Wire connection for the amplifier, the subwoofer and the headset monitors

Case 1: The subwoofer connects to the head unit

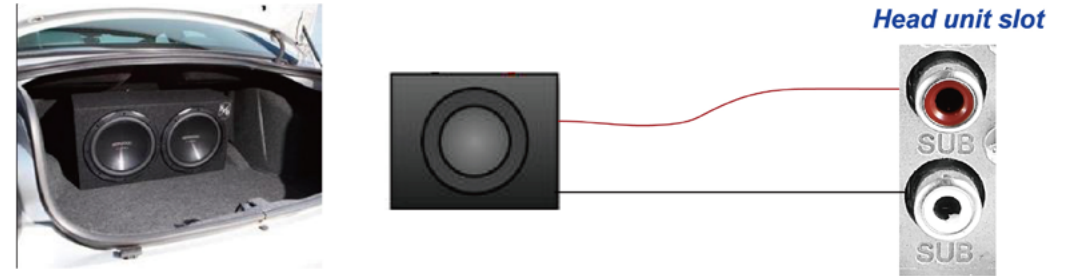

Case 2: The 2/4 speakers with an amplifier are connected to the head unit.

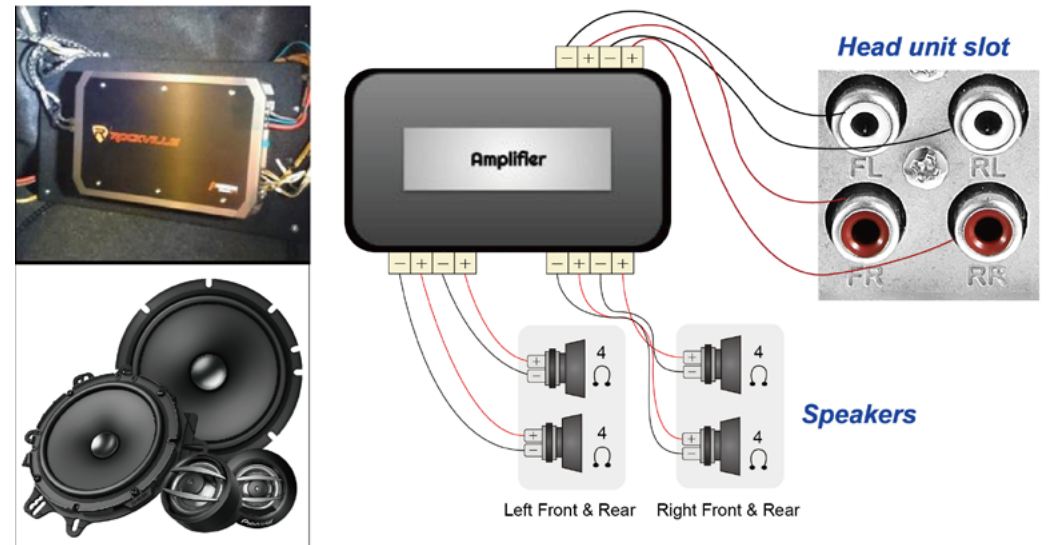

Case 3: The 2/4 speakers with an amplifier and the subwoofer with an amplifier are separately connected to the head unit.

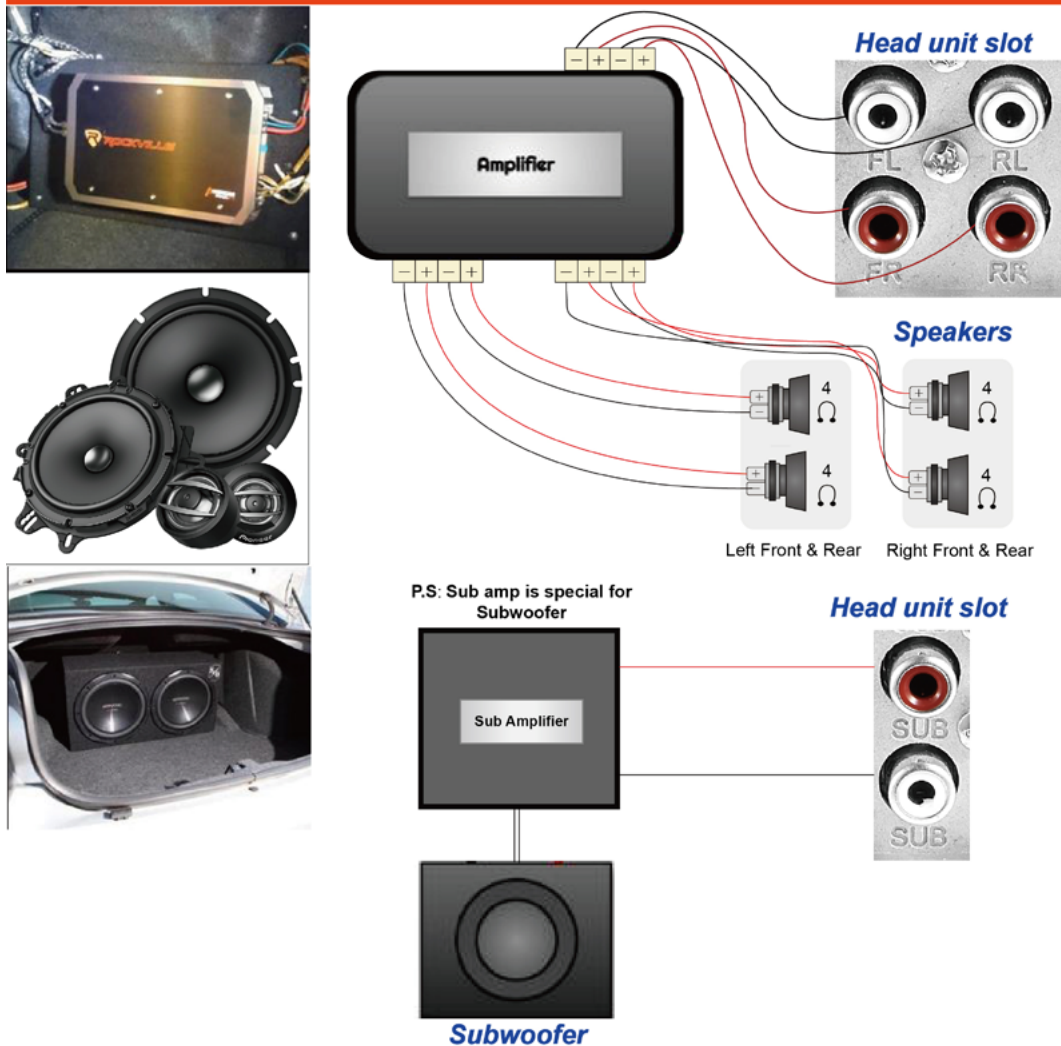

Case 4: The headrests monitors are connected to the head unit

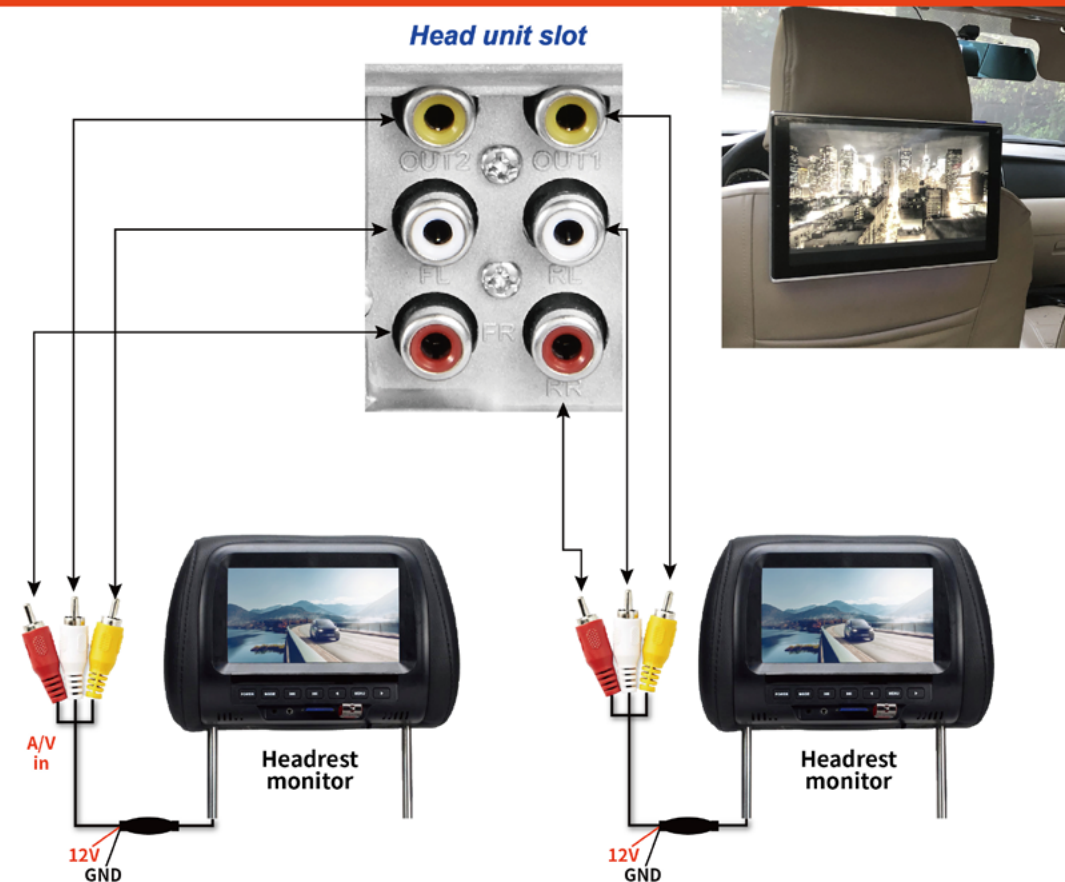

Except for connecting the amplifier, the slot of FL, FR, RL, RR also are used for connecting the headrest monitors.

Optional : Install a rear camera

Below is our rear camera. This will be a reference to teach you how to connect a rear camera to our head unit.



Connect to the rear camera control cable (Brown color) of head unit

Connect to the rear camera

Connect the 12v power cable of reverse gear

For fixing the position, it can lock with a screw

Connect to the CCD slot of the head unit

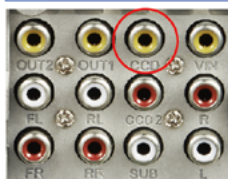

The ASIN of this rear camera has placed in the listing.

System Initial setup

1 Set radio location

The default radio country in the unit is Europe, if you are from other country, you need to access the "factory mode (PW: 126) > Radio" to adjust the country.

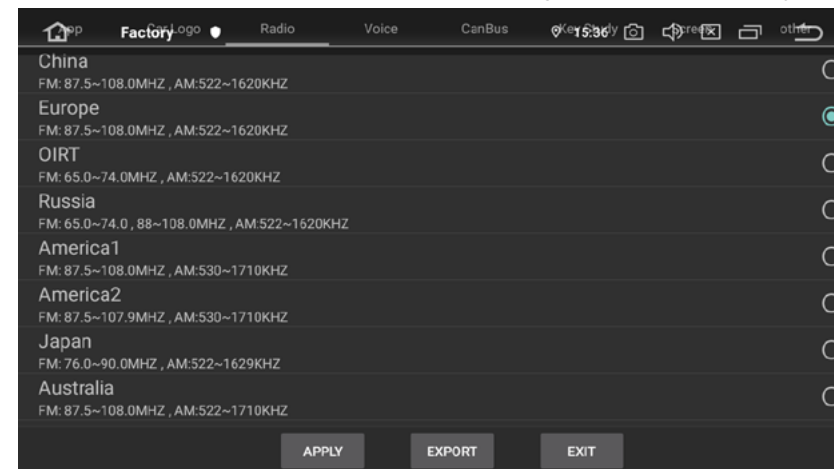

2 Set RDS

The Radio has RDS function but this function is only for Europe, if the clients from other countries use it, it will affect the radio reception, so please close it.



3 Set the unit language

Please go to setting > Languages & input, then you can add the desirable language you need.

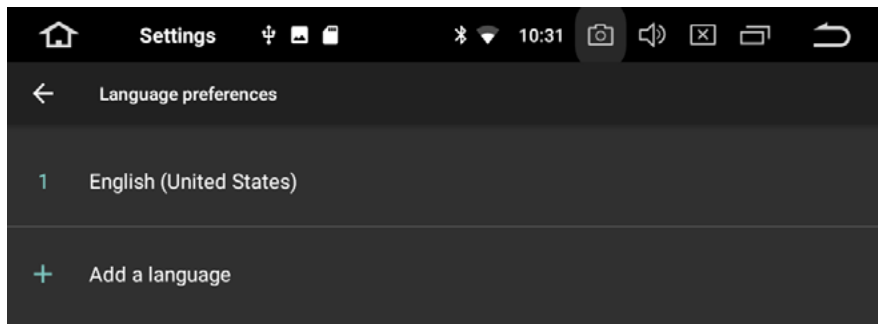

About after sales service

Q: Do my head unit has one year maintenance?

A: Definitely yes, you will have our commitment after you purchase.

(The maintenance period will base on the date you make the order)