



Installation manual



Benz W168 7-8inch Android

Are you ready to install our unit?

Let's go >>>

4 steps to install

STEP 01

Check

- 1) Do the screen is broken ?
- 2) Do the accessories have missing ?

STEP 02

Test your unit before a full installation.

(Connect the power cable to your car)

STEP 03

Do the full installation.

STEP 04

Test the head unit functions.

Accessories



1. USB adapter cable *1

2. GPS antenna *1

3. Wi-Fi antenna *1

4. 3M adhesive *1

5. Blue fuse *1

6. Nut *1 Gasket*2

7. Long screw *1

8. Short screw *4

9. Power cable *1

10. Factory Canbus adapter cable (A) *1

11. Factory Canbus adapter cable (B) *1

12. Disassembly tool *1

13. Radio antenna connector *1

14. Canbus *1

15. USB cable *1

Read me! Otherwise your car may output no sound

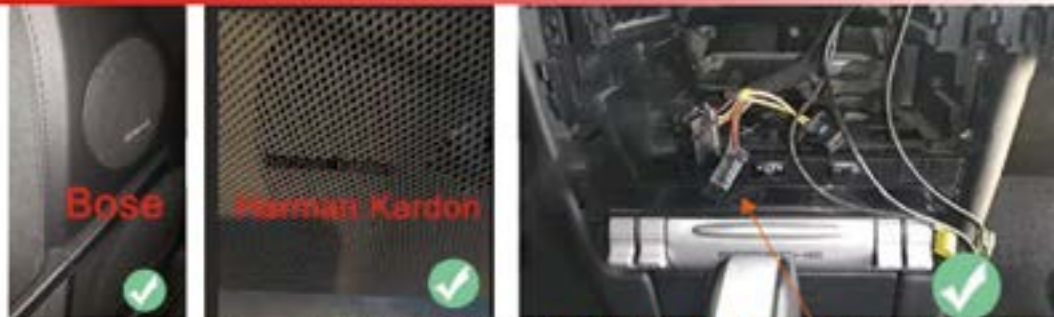

Please check if your car is built-in the optic fiber amplifier or Harman Kardon system or Bose sound system. If your car has these described systems, the installation won't plug and play.

You will need to separately purchase an Optical Fiber Decoder Box for the installation. Otherwise, your car can't output the sound after installing our head unit.



If your factory power plug like these, you will need the decoder box.



Base on your car models and year, select the ASIN of below decoder box to purchase.

ASIN : B0B1PCY681

Benz ML (2005-2011)
Benz GL (2005-2013)
Benz R (2005-2018)
Benz CLS (2009-2012)
Benz S W221 (2005-2012)
Benz SLK (2009-2012)

ASIN : B0B5YWLGD1

Benz CLS (2005-2008)
Benz E (2003-2008)
Benz S (2004-2006)
Benz SLK (2005-2008)
Benz CL (2004-2006)

ASIN : B0B5ZFBSJ5

Benz S/CL (2000-2003)
Benz E (2000-2003)
Benz SL (2003-2004)
Benz SL (2003-2004)
Benz C/CLK (2001-2004)
Benz ML (2000-2005)



If your factory power plug like the left photo, the installation can't plug and play. You will need to separately purchase an extended cable like Right photo for connecting to our head unit and to connect to the amplifier in the trunk area. This operation will be bypass the fiber optic cable !!



ASIN : B0B632L3JR

STEP 02 Test your unit before installing into your car (Connect the power cable to your car)

1. Double check the size and shape of the center console panel.



2. Well prepare below tools.



The installation methods among the application models are almost the same, below is the installation guide to show you how to install the unit to Benz W203.

3. First of all, remove the surrounded cover of gear knob.



4. Then pry out the cigarette console at the gap (red circle) with a screwdriver and take it out.

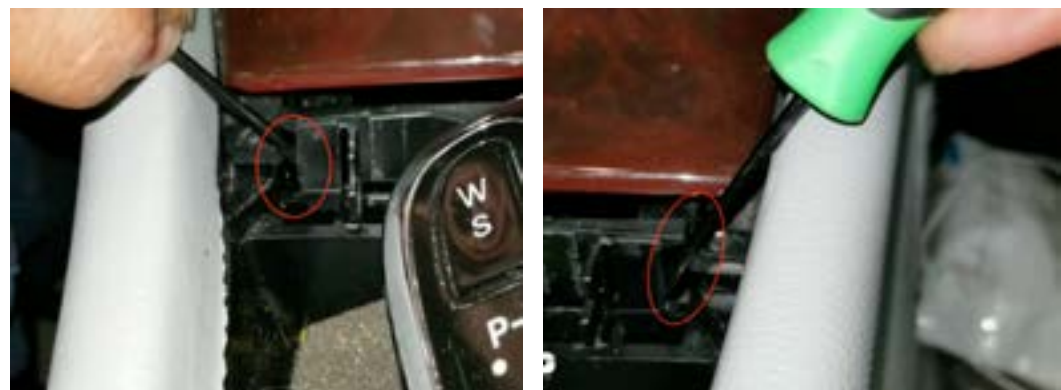

5. After that, go to remove the interior middle section air vents. Use the screwdriver to pull the inside switch in the air vents, then it will drop down. Besides, use the screwdriver to pry out the whole interior middle section air vents at the top of switch.



6. After removing the interior middle section air vents, you will find the screws at the left and right side that is used to lock the cover of center console, unscrew them.



7. Moreover, move to the middle of center console, you can easily pull out the cover of center console with the screwdriver at the position of red circle.





8. Now the factory old radio exposes out, you will see the screw at the left and right side, unscrew them.



9. Then the factory old radio and the storage box can be pulled out thoroughly.



Now you can take out the power cable to connect the head unit and then try to turn it on. If this part is no problem, you can do the remain steps.

STEP 03 Do the full installation.

10. Connect those wires provided in the package like (1) Power cable with canbus, (2) USB cable, (3) Radio antenna adapter cable, (4) GPS antenna, (5) Wi-fi antenna, (6) External microphone and (7) canbus cable as shown.

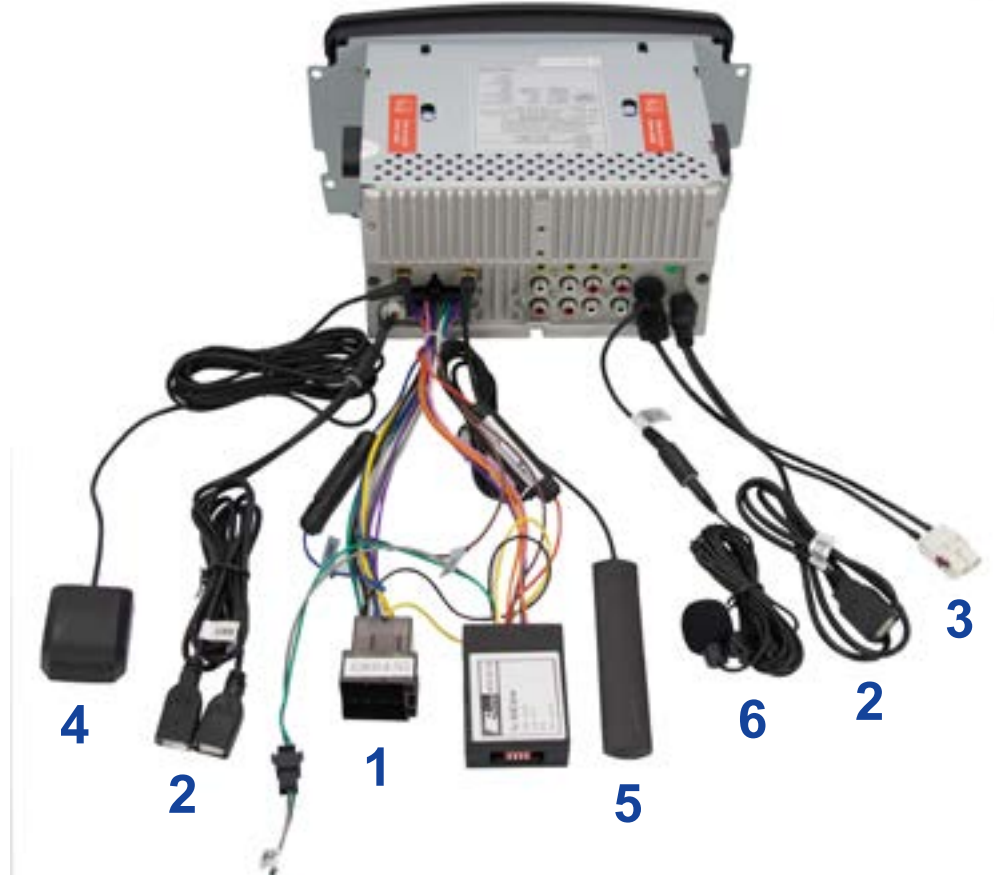

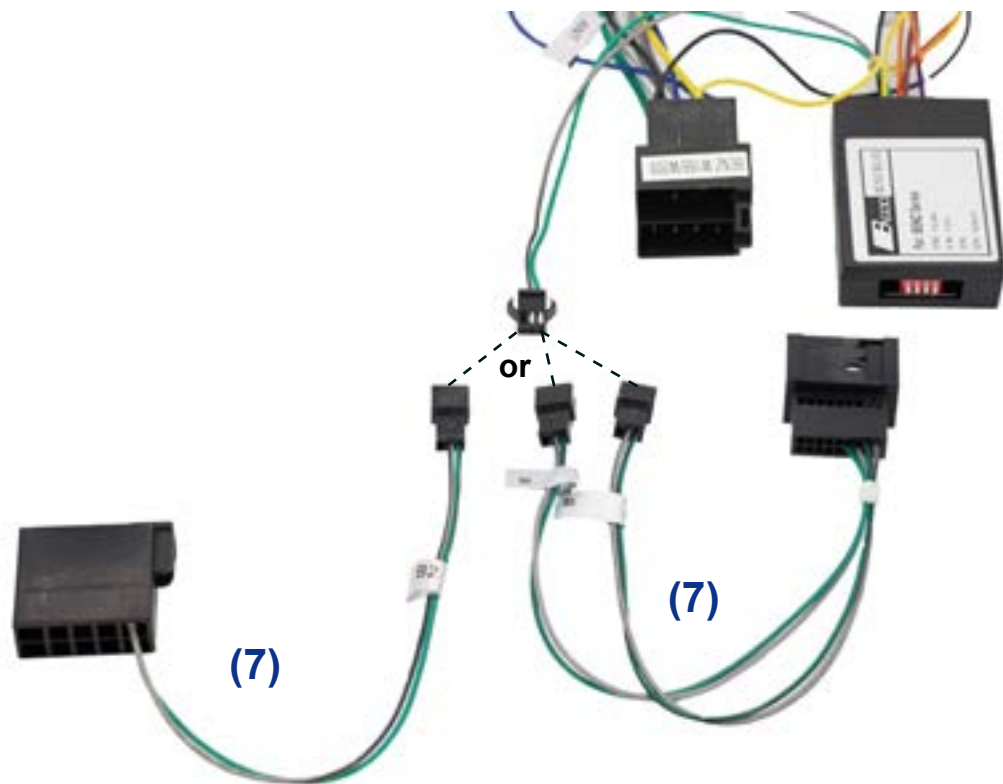

Remark:

Here are two canbus cables (7) provided in the package. Depend on the car model and year, we will only use one of the two canbus cables for the installation.

11. Set the canbus number following to the label.



Wiring diagram

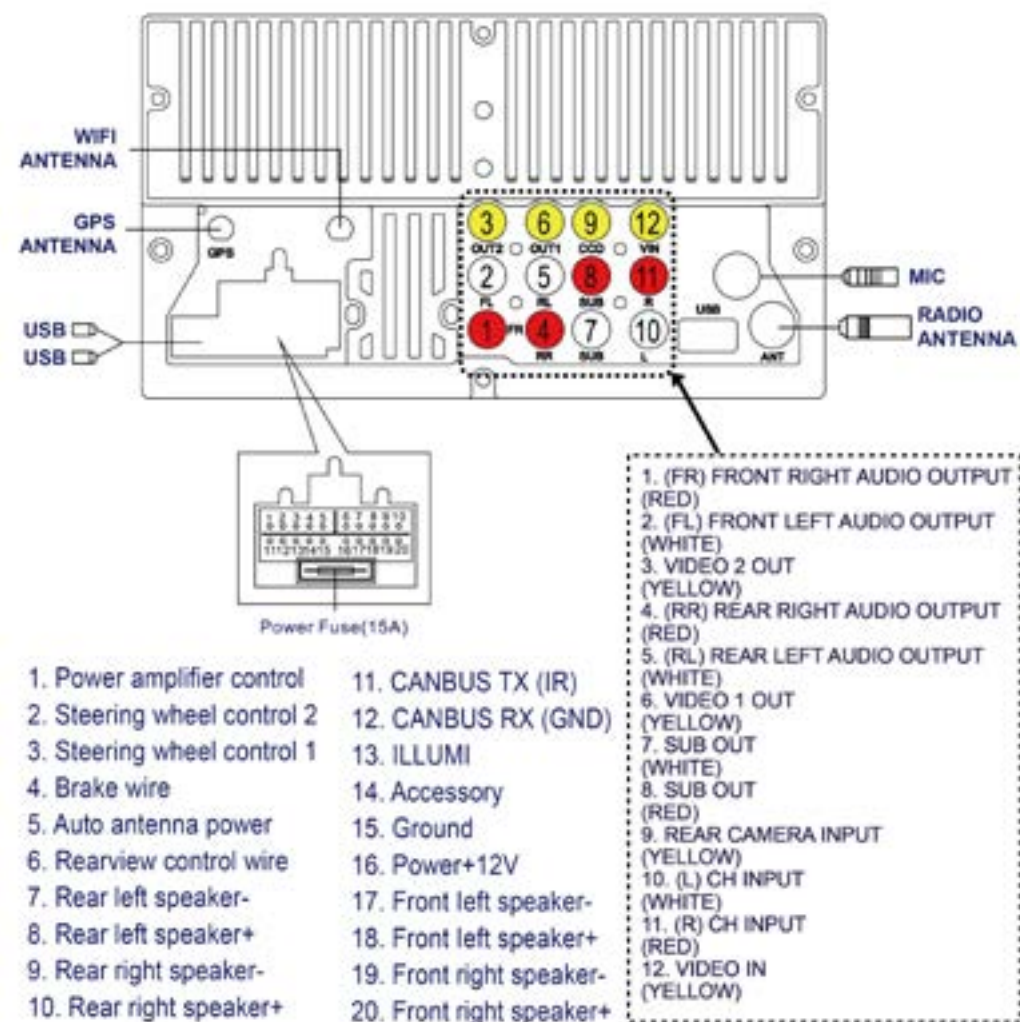

11. Place the GPS antenna and microphone as shown. The wires are hidden in the side of pillar trim and led to the head unit.

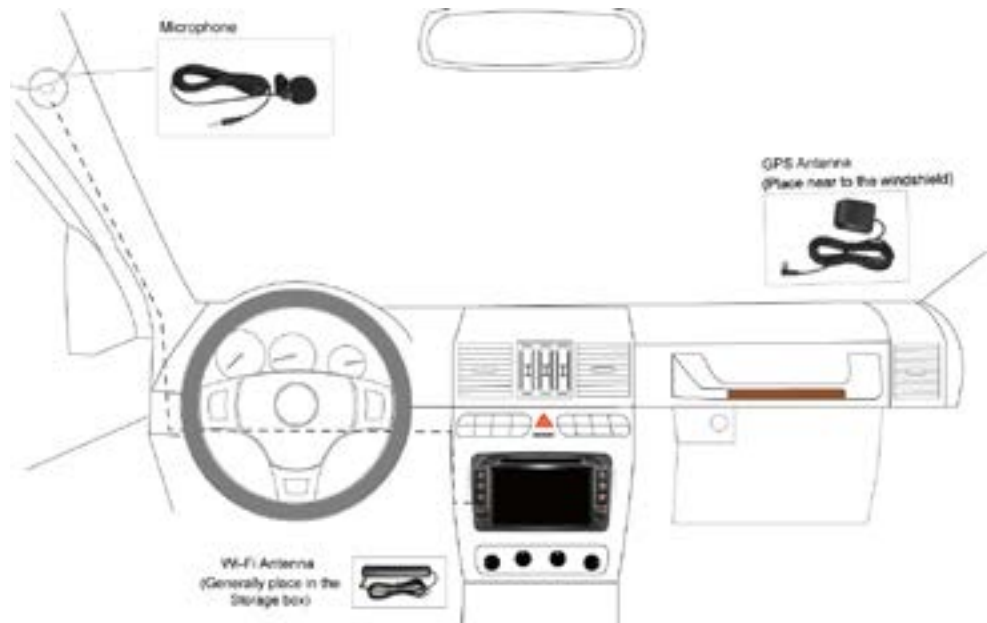

STEP 04 Test the head unit functions.

(FM, SD, USB, Bluetooth, reversing, handbrake, headlight, steering wheel control and etc)



Wire connection for the amplifier, the subwoofer and the headset monitors

Case 1: The subwoofer connects to the head unit



Case 2: The 2/4 speakers with an amplifier are connected to the head unit.

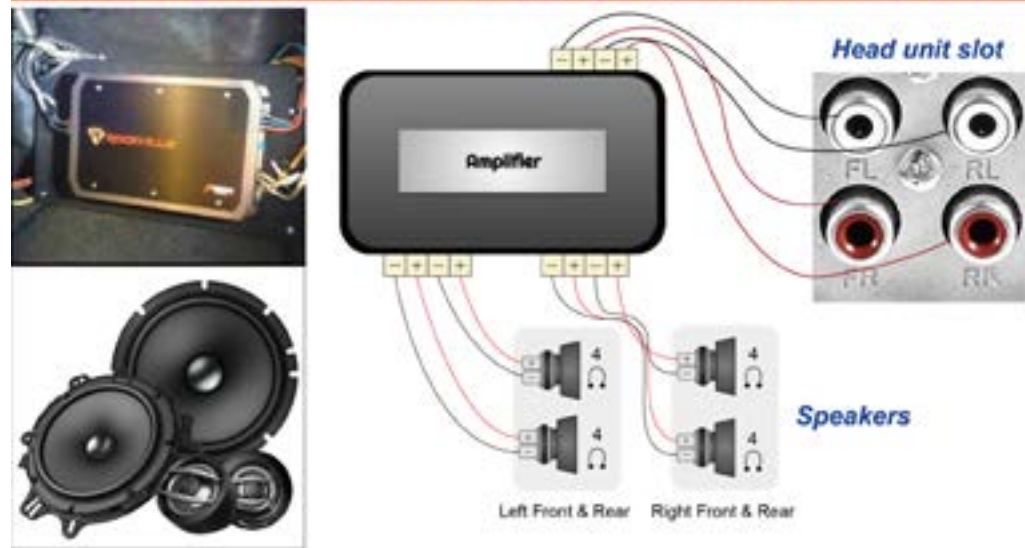

Case 3: The 2/4 speakers with an amplifier and the subwoofer with an amplifier are separately connected to the head unit.

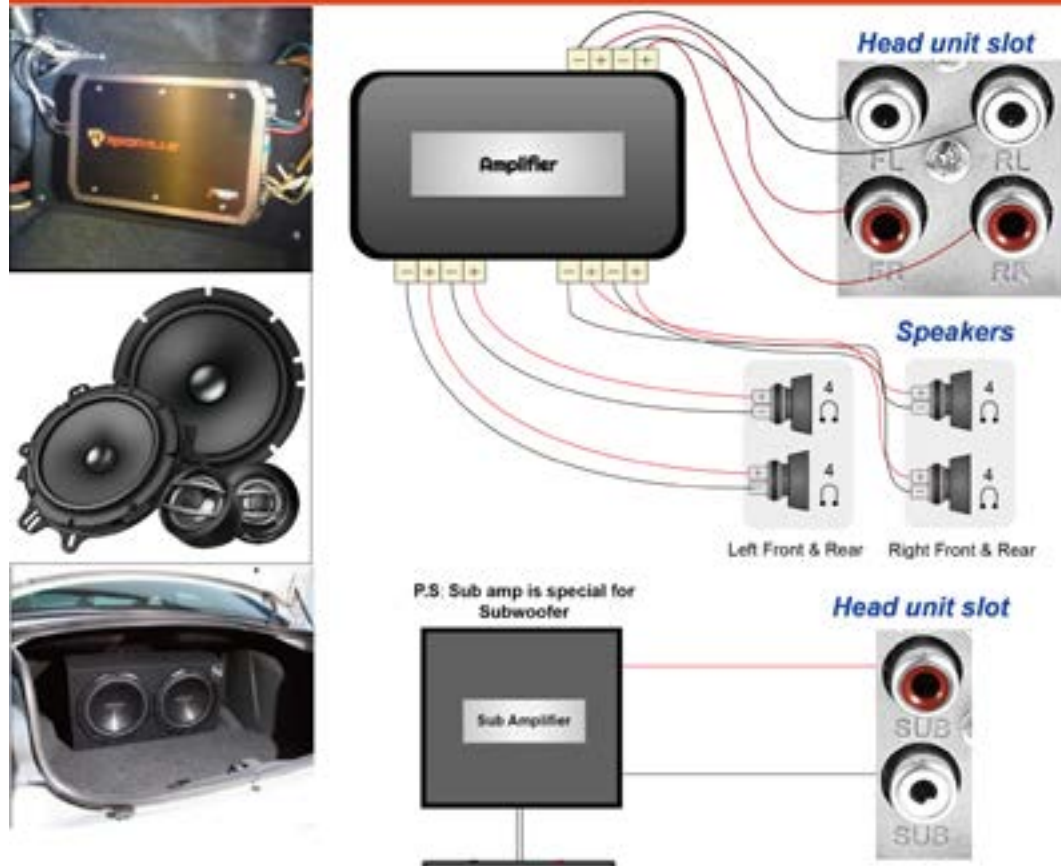

Case 4: The headrests monitors are connected to the head unit

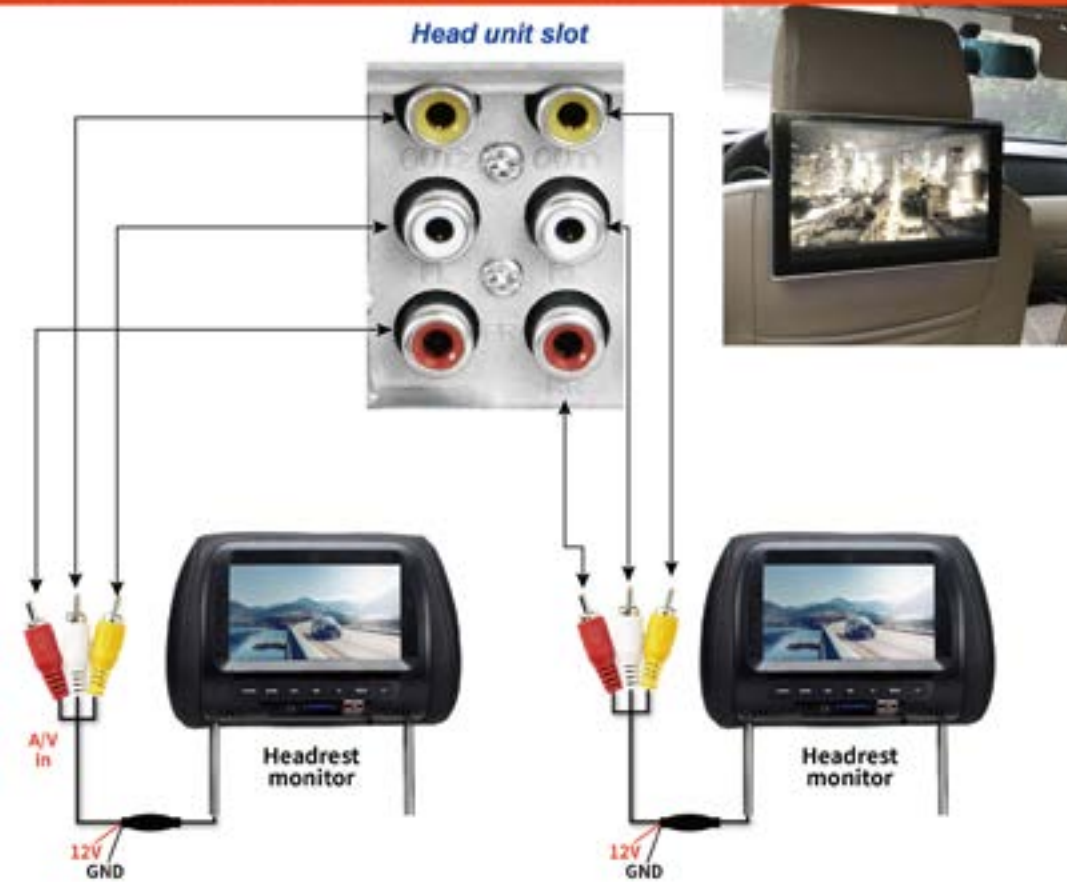

Except for connecting the amplifier, the slot of FL, FR, RL, RR also are used for connecting the headrest monitors.

Optional : Install a rear camera

Below is our rear camera. This will be a reference to teach you how to connect a rear camera to our head unit.



The ASIN of this rear camera has placed in the listing.

System Initial setup

1 Set radio location

The default radio country in the unit is Europe, if you are from other country, you need to access the "factory mode (PW: 126) > Radio" to adjust the country.

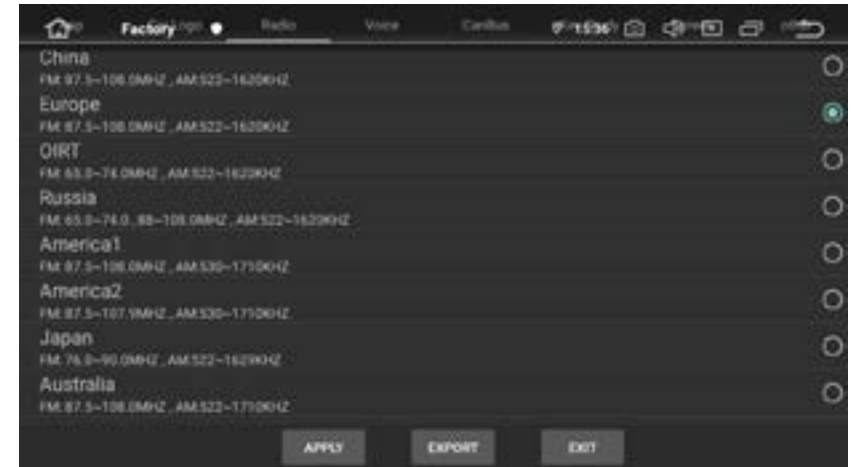

2 Set RDS

The Radio has RDS function but this function is only for Europe, if the clients from other countries use it, it will affect the radio receive, so please close it.



3 Set the unit language

Please go to setting > Languages & input, then you can add the desirable language you need.

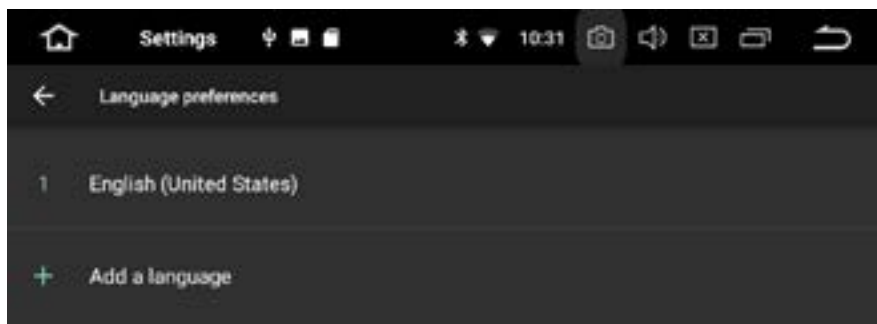

The detailed system and dsp user manual have been placed to our website, please find below QR code or linkage.



<https://amaseaudio-support.com/eng-faq>

About after sales service

Q: Do my head unit has one year maintenance?

A: Definitely yes, you will have our commitment after you purchase.

(The maintenance period will base on the date you make the order)